

FDLE

Florida Department of
Law Enforcement

INTERNAL INVESTIGATION REPORT

Incorporated by Reference in Rule 11B-27.003(2)(a), F.A.C.



CJSTC
78

Please type or print in black or blue ink and use capital and small letters for names, titles, and addresses

OFFICER

- 1. Social Security Number: [REDACTED]
- 2. Officer's Name: **McGuire, Shon D,**
- 3. Officer's Last Known Address: [REDACTED]
- 4. Officer's Telephone Number: [REDACTED]

AGENCY

- 5. Agency ORI: **FL0640000**
- 6. Agency Name: **Volusia County Sheriff's Office**
- 7. Agency Contact Person: **Lieutenant Erik Eagan**
- 8. Agency Contact Person's Telephone Number: **(386)736-5961**
- 9. Agency FAX Number: **(386)740-5190**

VIOLATION - ALLEGATION

- 10. Nature of Allegation(s): **Anonymous complaint of extramarital affair while on-duty.**
- 11. Agency Disposition: **Sustained - (Violation of Section 943.13(4) or (7) or Rule 11B-27.0011, F.A.C.)**
 Sustained - (Violation of Agency Policy) Not Sustained Unfounded Exonerated

- 12. Limitation Period for Disciplinary Action: _____ Date Internal Investigation Initiated: **03/09/2012** Date Internal Investigation Completed: **04/10/2012**
- Exception to limitation period for disciplinary action: Place a check mark by the exception to limitations that apply** **Days Tolled**
- Written waiver of limitation by officer
- Ongoing criminal investigation or criminal prosecution
- Officer incapacitated or unavailable
- Multi-jurisdictional investigation
- Emergency or natural disaster as declared by the Governor

- 13. Criminal Charges Filed: **N/A**
- 14. Agency Disciplinary Action: **N/A**

- 15. If the allegation has been sustained and determined to be a violation of Section 943.13(4) or (7), F.S. or Rule 11B-27.0011, F.A.C., attach and forward the following documentation to the Florida Department of Law Enforcement.
- Summary of the Facts Internal Investigation Report Name & Address of Witness
- Witness Statement/Disposition Certified Court Documents Other Supportive Information

NOTICE: Pursuant to Section 943.1395(5), F.S., an employing agency must conduct an internal investigation when having cause to suspect that an officer it employs is not in compliance with Section 943.13(4) or (7), F.S. or Rule 11B-27.0011, F.A.C. If the investigation is sustained, the employing agency must forward a report to the Commission as specified by Rule 11B-27.003.

Ben F. Johnson
16. Agency administrator's signature

April 10, 2012
17. Date Signed

Sheriff Ben F. Johnson
18. Agency administrator's name and title

**VOLUSIA COUNTY SHERIFF'S OFFICE
INTERNAL INVESTIGATION**

**REPORT NUMBER: IA-12-003
TABLE OF CONTENTS**

- A. Report of Investigation
- B. Official Correspondence
- C. Complaint
- D. Advisement of Rights and Administration of Oath
- E. Transcript of Sergeant Shon McGuire
- F. Miscellaneous Documents – AVL research
 - Melissa Murphy email
 - Operator 1652 (McGuire, Shon) Logon History (07-15-2011 thru 08-20-2011)
- G. AVL Sampling
- H. Audio CD of Recorded Interview

**VOLUSIA COUNTY SHERIFF'S OFFICE
INTERNAL AFFAIRS**

REPORT OF INVESTIGATION

REPORT NUMBER: IA-12-003

PERIOD COVERED: March 12, 2011 through March 12, 2012

DATE REPORTED: March 1, 2012

SUBJECT(S) NAME: Sergeant Shon McGuire # 1652

INVESTIGATING OFFICER: Lieutenant Erik Eagan # 2273

BASIS FOR INVESTIGATION:

On Friday, March 9, 2012, Lieutenant Erik Eagan met with Major Robert Jones in regards to an anonymous written complaint alleging Sergeant Shon McGuire was involved in an extramarital affair with Ms. Cara Gittner. Letter attached and made part of this investigation. *(See Tab - C)*

OFFENSE(S):

Volusia County Merit System Rules and Regulations 86-453 (13), Any conduct, on or off duty, that reflects unfavorably on the County as an employer. *This violation may be sufficient grounds for disciplinary action ranging from oral reprimand to dismissal, depending on the seriousness of the offense and other circumstances related to the situation.*

INVESTIGATIVE SUMMARY:

On Friday, March 9, 2012, Sheriff Ben Johnson assigned the above-described incident to the Internal Affairs Unit for investigation. This report details the investigation conducted by Lieutenant Erik Eagan.

On Friday, March 9, 2012, Sergeant Tom Tatum and Investigator Glen Bennett served Sergeant Shon McGuire with a Notice of Internal Investigation and provided him with a copy of the Law Enforcement Officer's Bill of Rights. *(See Tab - B)*

On Monday, March 12, 2012 Lieutenant Eagan reviewed the AVL data and conducted a search in Force Watch for possible contacts between Sergeant McGuire and Ms. Gittner's home, [REDACTED]. Lieutenant Eagan expanded the search area encompassing the entire peninsula where Ms. Gittner lives from March 12, 2011 until March 12, 2012. During this query Lieutenant Eagan noticed that on September 19, 2011 then Deputy McGuire drove

south on Atlantic Ave. [REDACTED] and west on Dunlawton Ave. to his home [REDACTED] FL.

There were also two matches in the AVL query that show Sergeant McGuire at Ms. Gittner's residence on July 22, 2011 for fourteen minutes and August 15, 2011 for an undetermined amount of time. Both incidents are when Sergeant McGuire was off-duty using his issued patrol car.

On Thursday, March 15, 2012 County Attorney Nancye Jones contacted Ms. Gittner's attorney, Melissa Murphy regarding Ms. Gittner participating in a witness interview for this investigation. On Friday, March 16, 2012 County Attorney Nancye Jones forwarded Lieutenant Eagan an email response from Ms. Murphy indicating that Ms. Gittner "...is declining to be interviewed as a witness."

Sergeant Shon McGuire

On Thursday, March 22, 2012, Lieutenant Eagan conducted a sworn recorded interview with Sergeant Shon McGuire at the Sheriff's Administrative Office in DeLand, FL. Also present at the interview was Sergeant Tom Tatum, Teamster's Representative Josh Vedder and Teamster's Business Agent Bob Walker. During the interview, Sergeant McGuire told investigators that he has not had an extramarital affair with Ms. Cara Gittner while on-duty. The two instances when Sergeant McGuire stopped by Ms. Gittner's home while in his issued patrol, he was off-duty. These instances were recorded by Sergeant McGuire's patrol car AVL (automated vehicle locator) on July 22, 2011 and August 15, 2011.

Lieutenant Eagan asked Sergeant McGuire if he has had problems with his AVL not functioning properly and he responded that he has. He said that his supervisor was aware of the AVL problems along with Information Systems. He said that his supervisor would inform him if his AVL was not updating his location and he would re-log onto his computer. Sergeant McGuire said that Information Systems had done something to his computer, AVL or both to remedy the problem. Sergeant McGuire denied disconnecting, interrupting or shutting down his computer to avoid AVL detection. Lieutenant Eagan was able to substantiate Sergeant McGuire's claim with his AVL problem and his constant re-logging onto the CAD system.

Sergeant McGuire was questioned if he felt he violated the below listed policies regarding this investigation. He denied violating any policies cited.

26.2.34 Failure to Follow Directive or Order - Employees shall adhere to all official Directives and/or orders, and shall faithfully execute all the duties and responsibilities of their assigned position. (Violation subject up to a 5 day suspension.) No

26.2.142 Use of Equipment: AVL - Employees shall ensure proper maintenance and utilization of the Department AVL (GPS) for its intended purpose and in accordance with installation requirements. No

26.2.143 Employees shall not intentionally cause the interruption of AVL equipment through purposeful acts of negligence or inattention. (Violation subject up to a 1 day suspension.) No

26.2.144 Any employee found to engage in such purposeful acts with intent to deceive the AVL system in order to avoid detection while on duty will be subject to disciplinary action up to dismissal. (New 06/09) No

82.7.62 It is the responsibility of the person assigned to the MDC to immediately inform their supervisor and Information Systems of AVL connectivity problems. If Information Systems determines that the issue requires the equipment to be repaired or replaced, the assignee will bring the equipment to Information Systems for service as soon as possible. No

86-453 (13) Volusia County Merit System Rules and Regulations - Any conduct, on or off duty, that reflects unfavorably on the County as an employer. This violation may be sufficient grounds for disciplinary action ranging from oral reprimand to dismissal, depending on the seriousness of the offense and other circumstances related to the situation. No
(See complete transcript - Tab - E)

Lieutenant Eagan contacted Information Systems to verify the work on Sergeant McGuire's computer/AVL and was informed that Information Systems does not keep a log of what computers they have worked on. Info Services Analyst Jeff Hart did not recall whether or not he had worked on Sergeant McGuire's computer and or AVL.

Conclusion:

On April 10, 2012 this investigation was presented to the Sheriff and his administrative staff. After review, the Sheriff determined the violations of the below listed Department Standards Directives to be:

26.2.34	Failure to Follow Directive or Order -	Unfounded
26.2.142	Use of Equipment: AVL -	Unfounded
26.2.143	Interruption of AVL equipment -	Unfounded
26.2.144	Deceive the AVL system -	Unfounded
82.7.62	AVL connectivity problems -	Unfounded
86-453 (13)	Volusia County Merit System Rules and Regulations -	Unfounded

EXHIBIT(S):

- A. Report of Investigation
- B. Official Correspondence
- C. Complaint
- D. Advisement of Rights and Administration of Oath
- E. Transcript of Sergeant Shon McGuire
- F. Miscellaneous Documents -- AVL research
Melissa Murphy email
Operator 1652 (McGuire, Shon) Logon History (07-15-2011 thru 08-20-2011)
- G. AVL Sampling
- H. Audio CD of Recorded Interview

WITNESSES:

Tim Jolley
Volusia County Sheriff's Office

I, the undersigned, do hereby swear, under the penalty of perjury, that, to the best of my personal knowledge, information, and belief, I have not knowingly or willfully deprived, or allowed another to deprive, the suspect of the investigation of any rights contained in ss. 112.532 and 112.533, Florida Statutes.

INVESTIGATOR: _____



Lieutenant E. Eagan
Internal Affairs Investigator

DATE: 04.10.12

APPROVED BY: _____



SHERIFF BEN F. JOHNSON
VOLUSIA COUNTY FLORIDA

DATE: 4/11/12

Sheriff



Ben F. Johnson

VOLUSIA COUNTY SHERIFF'S OFFICE

123 W. Indiana Avenue
P.O. Box 569
DeLand, FL 32721-0569

TO: Sergeant Shon McGuire #1652
Law Enforcement Services/ D-2

DATE: April 10, 2012

FROM: Ben F. Johnson
Sheriff

FILE: 040M0024.12

SUBJECT: Disposition of Internal Investigation

REFERENCE: IA-12-003

Based upon the facts presented in this investigation regarding Volusia County Merit System Rules and Regulations 86-453(13), the complaint has been classified as: **UNFOUNDED.**

The completed case file is retained in the files of the Volusia County Sheriff's Office, Internal Affairs Unit, located in Deland, Florida.

cc: Internal Affairs
File

Sheriff



Ben F. Johnson

VOLUSIA COUNTY SHERIFF'S OFFICE

123 W. Indiana Avenue
P.O. Box 569
DeLand, FL 32721-0569

TO: Sergeant Shon McGuire #1652
Law Enforcement Services/ D-2

DATE: March 9, 2012

FROM: Ben F. Johnson
Sheriff

FILE: 040M0019.12

SUBJECT: Notification of Internal Investigation

REFERENCE: IA-12-003

Pursuant to **STANDARD 52.1.58** you are hereby notified that you are the subject of an internal investigation. The complainant in this case is Sheriff Ben Johnson.

This investigation is relevant to an alleged violation of Department Standards Directives:

Volusia County Merit System Rules and Regulations 86-453 (13). Any conduct, on or off duty, that reflects unfavorably on the County as an employer. *This violation may be sufficient grounds for disciplinary action ranging from oral reprimand to dismissal, depending on the seriousness of the offense and other circumstances related to the situation.*

The alleged violation is reported to have occurred in July 2011.

Enclosed please find a copy of the Law Enforcement Officer's Rights which includes your rights and responsibilities relevant to this investigation.

Be advised that you are prohibited from contacting the complainant and/or witnesses relative to this investigation.

An appointment will be made with you at a later date for the purpose of taking your statement.

This memo read and received by:
Sergeant Shon McGuire #1652

Date: 03-09-2012

Time: 15:46

BJ/ee 040M0019.12

Sheriff Johnson,

It seems that you've had some problems lately with your supervisory staff and their behavior. Since the subject has come up, there are many more within your organization at a supervisory level responsible for similar type behavior.

One in particular, is Sergeant Shon McGuire. He has been involved in an extra-marital affair for several months with the Beach Patrol Officer, Cara Gittner. If you recall, she was the same officer that resigned from the Beach Patrol after being accused of having an affair with Capt. Rich Gardner of the Beach Patrol.

If you were to check the history on his patrol car GPS, you would see that starting in mid to late July of 2011, Sgt. McGuire took his issued vehicle to Officer Gittner's residence, sometimes while on duty at the end or start of his shift.

In my opinion, Sgt. McGuire should not conduct himself in this manner when he expects his Deputies under his command to conduct themselves accordingly.

A Loyal Deputy

POSTAGE WILL BE PAID BY ADDRESSEE
FIRST CLASS PERMIT NO. 2089
DELAND, FL 32721



SHERIFF BEN JOHNSON
Volusia County Sheriff's Office
P.O. Box 569
DeLand, FL 32721

32721+0569



ADVISEMENT OF RIGHTS FOR A DISCIPLINARY INTERVIEW

I wish to advise you that you are being questioned as part of an official investigation of the Volusia County Sheriff's Office. You will be asked questions specifically directed and narrowly related to the performance of your official duties or fitness for office. You are entitled to all rights and privileges guaranteed by the laws and the constitution of this state and the constitution of the United States, including the right not to be compelled to incriminate yourself. I further wish to advise you that if you refuse to testify or to answer questions relating to the performance of your official duties or fitness for duty, it will be considered an act of insubordination and a violation of a direct order by a superior or competent authority. If you do answer, neither your statements nor any information or evidence, which is gained by reason of such statements, can be used against you in any subsequent criminal proceeding, **(except for perjury or obstruction of justice charges)**. However, these statements may be used against you in relation to subsequent department charges.

The aforementioned Advisement of Rights is not the warning in criminal cases under the Miranda decision. As mentioned, Miranda has no application in a disciplinary interview.

Stef. S. McCuire McCuire
Signature

3-22-2011 03.22.2012
Date

VCSSO Admin - IA
Location

Witnessed By:

[Signature]
Tatum

[Signature]
Tatum

VOLUSIA COUNTY SHERIFF'S OFFICE
OFFICE OF INTERNAL AFFAIRS

ADMINISTRATION OF OATH / PERJURY WARNING

Case Number: IA-12-003

Subject Name: Sergeant Shon McGuire

I am LT Erik Eagan with the Volusia County Sheriff's Office, Internal Affairs Unit. Today's date is March 22, 2012 and the current time is 1422

The location of this interview is, Internal Affairs Office at the Sheriff's Administrative Building, 4th floor. Also present during this interview is Sergeant Tom Tatum, with the Volusia County Sheriff's Office Internal Affairs unit and would you mind if he asked you any questions during the interview? Also present is/are

Are you aware that this interview is being recorded? yes.
Answer

I am conducting an official administrative investigation concerning:

86-453 (13) Volusia County Merit System Rules and Regulations - Any conduct, on or off duty, that reflects unfavorably on the County as an employer. This violation may be sufficient grounds for disciplinary action ranging from oral reprimand to dismissal, depending on the seriousness of the offense and other circumstances related to the situation.

As a Florida Law Enforcement Officer and a Notary Public of the State of Florida, I am empowered to take sworn statements. At this time, I would ask that you raise your right hand to be sworn. Do you solemnly swear or affirm that the statement you are about to give is the truth, the whole truth, and nothing but the truth?

Any false statements about material matters given by a witness under oath will constitute perjury, which is a Third Degree Felony according to Section 837.02, Florida Statutes.

Do you understand that if you knowingly make material mis-statements of facts to me during this investigation, you will have committed the crime of perjury? yes.
Answer



Witness Signature

03/22/12

Date

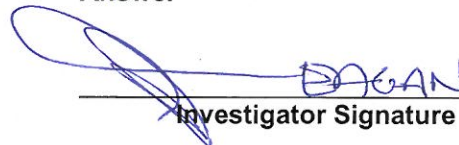

Investigator Signature

WITNESS STATEMENT

EE – Lt. Erik Eagan TT – Sgt. Tom Tatum SM – Dep. Shon McGuire
JV – Dep. Josh Vedder (Teamster Rep) BW – Bob Walker (Teamster Rep)

EE The recorder is on. This is the administration of oath and perjury warning, case number IA-12-003. Subject's name is Sgt. Shon McGuire. I'm Lt. Erik Eagan Volusia County Sheriff's Office Internal Affairs Unit. Today's date is March 22, 2012, and the current time is 1422 hours. The location of the interview is the internal affairs interview office at the Sheriff's administration building 4th floor. Also present during the interview is Sgt. Tom Tatum with Volusia County Sheriff's Office Internal Affairs Unit, and would you mind if he asked you any questions during the interview?

SM Sgt. Tatum, no sir.

EE Ok.

SM That's fine.

EE Also present is Dep. Josh Vedder and I forgot...

TT Bob Walker.

JV Bob Walker.

EE Bob Walker, Bob I apologize.

BW That's ok.

EE Are you also aware that the interview is being recorded?

SM Yes sir.

EE Ok, I'm conducting an official administrative investigation concerning 86-453.13 Volusia County Merit System Rules and Regulations. Any conduct on or off duty that reflects unfavorably on the county as an employer. This violation may be sufficient grounds for disciplinary action ranging from oral reprimand to dismissal depending on the seriousness of the offense and other circumstances related to the situation. As a Florida law enforcement officer and Notary Public of the state of Florida I am empowered to take sworn statements. At this time I would ask that you raise your right hand and be sworn. Do you solemnly swear or affirm that the statement you're about to give is the truth, the whole truth, and nothing but the truth?

SM Yes sir.

47
48 EE Any false statements about material matters given by a witness under oath will
49 constitute perjury which is a third degree felony according to section 837.02
50 Florida Statutes. Do you understand that if you knowingly make material
51 misstatements of facts to me during this investigation you will have committed
52 the crime of perjury?
53
54 SM Yes sir.
55
56 EE For the record Sgt. McGuire could you please spell your last name?
57
58 SM M-C-G-U-I-R-E
59
60 EE Ok, Sgt. McGuire you were served with your notification of internal investigation
61 did you receive a copy of your law enforcement bill of rights?
62
63 SM Yes sir.
64
65 EE Ok I believe I also provided you another copy in the packet that I gave you.
66
67 SM Yes sir.
68
69 EE Ok before we go in on record did you read and sign your advisement of rights as
70 they pertain to Garrity?
71
72 SM Yes sir.
73
74 EE Ok. Have you had a chance to review all documents provided to you regarding
75 this investigation?
76
77 SM Yes sir.
78
79 EE Ok do you need any more time to review these documents?
80
81 SM No sir.
82
83 EE Alright Sgt. McGuire how long have you been employed by the Volusia County
84 Sheriff's Office?
85
86 SM A little over nine years.
87
88 EE Ok what assignments have you held with the Sheriff's Office?
89
90 SM Basically I've been in patrol the whole time and an FTO and recently promoted to
91 Sergeant.
92

93 EE Ok so your current assignment is Sergeant?
94
95 SM Yes sir.
96
97 EE In road patrol, ok. You're here today because we received information that you
98 may be or may have been involved in an extra marital affair while on duty. Do
99 you know Cara Gittner?
100
101 SM Yes sir.
102
103 EE Ok what is your relationship with her?
104
105 SM She's a friend.
106
107 EE Are you or have you been in a romantic relationship with her?
108
109 SM While working? I mean...
110
111 EE Let me ask the question again. Are you or have you been in a romantic
112 relationship with her?
113
114 SM Yes.
115
116 EE Ok. How long have you been involved in a romantic relationship with Ms.
117 Gittner?
118
119 SM I'm not now.
120
121 EE Ok how long have you been?
122
123 SM I don't know we were friends for a couple months at the most.
124
125 EE Ok so the answer to your question or to my question how long...
126
127 SM I don't know the exacts.
128
129 EE Ok.
130
131 SM The exact I'm sorry.
132
133 EE Approximately?
134
135 SM Two months?
136
137 EE Ok. Have you ever visited her while you were on duty?
138

139 SM No sir.
140
141 EE Ok. Have you ever met her while you were on duty, excuse me, have you ever
142 met her while you were off duty but still in uniform?
143
144 SM Yes sir.
145
146 EE Ok when was this?
147
148 SM I don't know the exact date.
149
150 EE Ok do you know where it occurred?
151
152 SM I stopped by her house.
153
154 EE Ok anywhere else?
155
156 SM Not that I can recall.
157
158 EE Ok have you and Ms. Gittner exchanged text messages while you were on duty?
159
160 SM Yes sir.
161
162 EE Ok what was the content of those text messages?
163
164 SM I mean they range, I don't remember the exact content I mean it was, I mean I
165 don't know everything from just friend stuff.
166
167 EE Ok have you and Ms. Gittner exchanged phone calls while you were on duty?
168
169 SM Yes sir.
170
171 EE Ok what was the content of those phone calls?
172
173 SM We just you know talked like friends or sometimes it was even work related. I
174 really don't know the exact what we talked about.
175
176 EE Ok.
177
178 SM I'm not trying to hide anything I just don't remember exactly what we talked
179 about.
180
181 EE No and I, all I'm asking for Sgt. McGuire is that you be completely honest with
182 me.
183
184 SM Yes sir.

185
186 EE Are you married?
187
188 SM Yes sir.
189
190 EE How long have you been married?
191
192 SM Coming up two years.
193
194 EE Ok. On July 22, 2011 were you off duty or on duty? And let me show you this.
195 This is a CAD print out for July 22nd.
196
197 SM Looks like I was off duty.
198
199 EE How do you know that you were off duty?
200
201 SM It shows I was logged on by my ID number.
202
203 EE Ok and would that in and of itself indicate that you were off duty?
204
205 SM And the time it's after, I mean I worked I was on days I worked 6 to 6 during the
206 day and that's after 6pm.
207
208 EE Ok well what I'm trying to clarify is when you're on duty you log on as a patrol
209 unit.
210
211 SM Yes sir.
212
213 EE Do you log on off duty for off duty details? Would that be indicated?
214
215 SM Yeah I guess but when I log on for work it's you know the 1B34 and this is by my
216 ID so I would imagine I was off duty yes sir.
217
218 EE Ok. Alright, well if it helps your recollection we can go to the actual print out for
219 that date, would that help?
220
221 SM Yeah.
222
223 EE Does that help your recollection?
224
225 SM Yeah it shows me it looks like I was 10-75.
226
227 EE Ok well let me ask you this, if you were off, working an off duty detail would you
228 sign out at that detail?
229
230 SM Yes sir.

231
232 EE So you would know based on the CAD record...
233
234 SM Yes sir.
235
236 EE ...whether or not you're working a detail?
237
238 SM Yes sir.
239
240 EE Ok. So I don't want to put words in your mouth but based on your review of this
241 you were off duty?
242
243 SM Yes sir.
244
245 EE Ok. On August 15th were you off duty or on duty?
246
247 SM I was off duty.
248
249 EE Ok. Do you want to look at your CAD history?
250
251 SM I guess we can yeah, yes sir.
252
253 EE I just want to make sure that you're positive. Does this help? This is a print out
254 from that date.
255
256 SM Yes sir I was off duty.
257
258 EE And how do you know that you were off duty?
259
260 SM Same thing, I was logged on by my ID number and not logged out anywhere.
261
262 EE Ok. Have you ever had any problems with your AVL your automated vehicle
263 locator not connecting properly?
264
265 SM Yes sir.
266
267 EE Ok have you reported these problems to your supervisor?
268
269 SM Yes sir and she's made me aware at times she would tell us, she would send us a
270 message saying you know "it looks like you're disconnected" and then I'd reboot
271 it.
272
273 EE Ok have you reported these problems to info systems?
274
275 SM Yeah I've gotten a new AVL and stuff out there before, or a new you know the
276 card.

277
278 EE Ok. Have you ever intentionally disconnected or interrupted your AVL or shut
279 down your computer to avoid being detected?
280
281 SM No sir.
282
283 EE Sgt. Tatum do you have any questions?
284
285 TT Yeah Shon if we could just go back to the question where you said that you were
286 in uniform when you visited her one time.
287
288 SM Yes sir.
289
290 TT Do you recall what you were doing at that point?
291
292 SM I was just stopping by to see her.
293
294 TT So you were working a zone at that point?
295
296 SM No I never stopped by her house when I was working. I mean it was after work I
297 stopped by on my way home.
298
299 TT Ok so it was after work but you were still in uniform when you stopped by?
300
301 SM Yes sir.
302
303 TT It was after hours?
304
305 SM Yes sir.
306
307 TT Ok. Do you know how long you stayed at the house?
308
309 SM No sir.
310
311 TT And you don't recall what date that was that...
312
313 SM No sir.
314
315 TT ...you stopped by?
316
317 EE On the July 22, 2011 you stopped by her residence based on your AVL history.
318
319 SM Yes sir.
320
321 EE Was that the day that you stopped by in uniform or was August 15th?
322

323 SM From that I don't know, I don't remember exactly what day it was I stopped by
324 after work.
325
326 EE Ok.
327
328 TT So if you stopped by there when you were off work were you in your patrol car?
329
330 SM Yes sir.
331
332 TT And you were, you said you were in uniform right so, ok.
333
334 EE Do you have anything else?
335
336 TT No.
337
338 EE Ok Sgt. McGuire I'm going to ask you if you felt like you violated any of these
339 policies or the following directives. 26.2.34 Failure to follow directive or order-
340 Employees shall adhere to all official directives and/or orders and shall faithfully
341 execute all the duties and responsibilities of their assigned position.
342
343 SM I don't feel like I violated that no sir.
344
345 EE Ok. 26.2.142 Use of equipment specifically your AVL, employees shall ensure
346 proper maintenance and utilization of the department AVL parenthetically GPS
347 for its intended purpose and/or accordance with installation requirements.
348
349 SM No sir.
350
351 EE 26.2.143 Employees shall not intentionally cause the interruption of AVL
352 equipment through purposeful acts of negligence or inattention.
353
354 SM No sir.
355
356 EE Ok 26.2.144 Any employee found engaged in such purposeful acts with intent to
357 deceive the AVL system in order to avoid detection while on duty will be subject
358 to disciplinary action up to dismissal.
359
360 SM No sir.
361
362 EE 82.7.62 is responsibility of person assigned to the MDC to immediately inform
363 their supervisor and information systems of AVL connectivity problems. If info
364 systems determines that the issue requires equipment to be repaired or replaced
365 the assignee will bring the equipment to information systems for service as soon
366 as possible.
367
368 SM No sir.

369
370 EE 86-453.13 Volusia County Merit Rules and Regulations. Any conduct on or off
371 duty that reflects unfavorably on the county as an employer. This violation may
372 be sufficient grounds for disciplinary action ranging from oral reprimand to
373 dismissal depending on the seriousness of the offense and other circumstances
374 related to the situation.
375
376 SM No sir.
377
378 EE Do you gentlemen have anything?
379
380 JV I do. The way the AVL works when you're on patrol and you're logged on and
381 the AVL is connected is there anyway for you to tell on your computer that the
382 AVL is no longer connected? Does it give you a visual sign, does a light turn red,
383 is there some way for you to tell by looking at your computer that the AVL is not
384 connected or disconnected?
385
386 SM No. Not unless you're intentionally looking for that.
387
388 JV Intentionally looking as how?
389
390 SM Like when you, when you're able to hit the pause break to see where everybody is
391 and then it'll say that you know you're not connected or say reverse geo and then
392 it might say DC next to it but it doesn't say you know on the main screen.
393
394 JV Do you regularly look at where everyone is and the AVL status?
395
396 SM No not always.
397
398 JV Is that a common feature that you would do regularly in the course of your duties?
399
400 SM Now I do yes sir.
401
402 JV As a...
403
404 SM As a Sergeant.
405
406 JV Because you're a...
407
408 SM Checking on my guys yes sir.
409
410 JV Ok, and on the AVL you said that at one point you had taken the computer back
411 to info systems to have the AVL unit itself replaced?
412
413 SM I've taken my computer out there many times for many things. Even for
414 especially for the GPS.

415
416 JV And did they replace the AVL?
417
418 SM I believe so. Or they fixed it, they messed with it I don't know what they did.
419
420 JV Ok.
421
422 BW Just a quick question from me guys. What is the county's policy on anonymous
423 complaints? Are you guys, are you obligated to...
424
425 EE I can tell you the Sheriff's Office policy is yes we will investigate all complaints
426 including anonymous complaints.
427
428 TT Uh huh.
429
430 BW Ok. If someone gets a little antsy and starts writing a lot of letters I'm going to be
431 coming out here a lot so. I like you guys but I don't want to spend all my time out
432 here. I have nothing.
433
434 EE Sgt. McGuire is there anything that you want to add or delete from your
435 statement?
436
437 SM No sir.
438
439 EE Ok. I want to thank you for coming out and speaking with us today. This will
440 conclude the interview, the time is 1437 hours.
441
442
443
444
445
446
447
448
449
450
451
452
453
454
455
456
457
458
459
460

461
462
463
464
465
466
467
468
469
470
471
472
473
474
475
476
477
478
479
480
481
482
483
484
485

I, Lt. Erik Eagan, swear that the forgoing is an accurate transcription of the sworn recorded statement of Sgt. Shon McGuire taken by me on March 22, 2012.

(Signed)

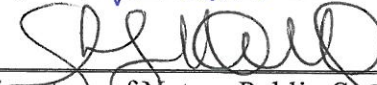

Sworn to and subscribed before me this 22
Day of MARCH, 2012.

Signature of Notary Public-State of Florida



(Print, type or Stamp Commissioned Name of Notary Public)

My Commission Expires:

My Commission Number is:

Personally Known

Produced identification

Type of Identification Produced

Eagan, Erik

From: Jones, Robert
Sent: Friday, March 09, 2012 8:50 AM
To: Eagan, Erik
Subject: FW: AVL Data
Follow Up Flag: Follow up
Flag Status: Red
Attachments: 1652 2011-07-22 Arrival.JPG; 1652 2011-07-22 Departure.JPG; 1652 2011-08-15 Arrival.JPG; 1652 2011-08-15 Remainder.JPG; 1652 CAD Unit History 2011-08-15.pdf

From: Jolley, Tim
Sent: Thursday, March 08, 2012 12:59 PM
To: Jones, Robert
Subject: AVL Data

Major,

Sorry it took so long to get you this information. As I mentioned we saw some discrepancies and wanted to verify what was happening. We only found AVL data for two days for the addresses provided. Both instances are outlined below and occurred while he was 10-75. I've also attached screenshots of the data.

- 7/22/2011 (1857 hours) – Arrives and stops in the area of [REDACTED]
- 7/22/2011 (1911 hours) – Departs the area of [REDACTED]
- 8/15/2011 (0917 hours) – Arrives in the area. Unsure if the unit stops because the last coordinate reported was heading NW at 33.8 MPH. (see file "1652 2011-08-15 Arrival.JPG")
- 8/15/2011 (1043 hours) – At the intersection of Dunlawton / US1 in Port Orange. This is the first coordinate received since 0917 hours (see file "1652 2011-08-15 Remainder.JPG")

As you can see, there is an unexplained gap in the AVL data on 8/15/2011. There are a few possible causes for such a gap. For example, we will not receive coordinates if the MDC is turned off, loses satellite signal (e.g. inside a building), or cellular (i.e. Sprint) connectivity. We will also see an interruption of AVL data if the GPS antenna is malfunctioning or is unplugged. In order to help isolate the cause in this case, we looked at the remaining AVL coordinates (see file "1652 2011-08-15 Remainder.JPG") on that date and found the following:

- 1043 hours – After approximately 86 minutes with no AVL activity, the unit starts transmitting AVL coordinates again at the intersection of Dunlawton / US1.
- 1054 hours – Last AVL coordinate reported for the day showing the unit heading north at 32.5 MPH on City Center Parkway in Port Orange (i.e. by old POPD location).
- 1257 hours – Unit runs a tag from his MDC (see file "1652 CAD Unit History 2011-08-15.PDF")
- 1300 hours – Unit logs out of CAD from his MDC (see file "1652 CAD Unit History 2011-08-15.PDF")

3/9/2012

Based upon the above information, I suspect that he is unplugging his GPS antenna. For example, it seems that his MDC was on and he had cellular service during the three minutes when he ran the tag from his MDC and logged out of CAD. Therefore, we can eliminate his MDC being off or no cellular service. If you are inside a building, then it is possible to have a cellular signal, but no satellite signal. However, why would he be running a tag while inside? The GPS antenna could also be malfunctioning, but that is unlikely since it was obviously working earlier. If he is in the habit of unplugging the device, then that may explain why we only saw him in that area on a couple of days. I would suggest that someone start spot checking a few days of his AVL data.

To help identify deliberate attempts to circumvent AVL in the future, I've asked that my staff to begin looking at developing a routine that will log / alert anytime the MDC is on and it does not detect a GPS antenna connected. However, at this time, I don't have a timeframe on when I can get that implemented.

Let me know if you need anything else.

Tim

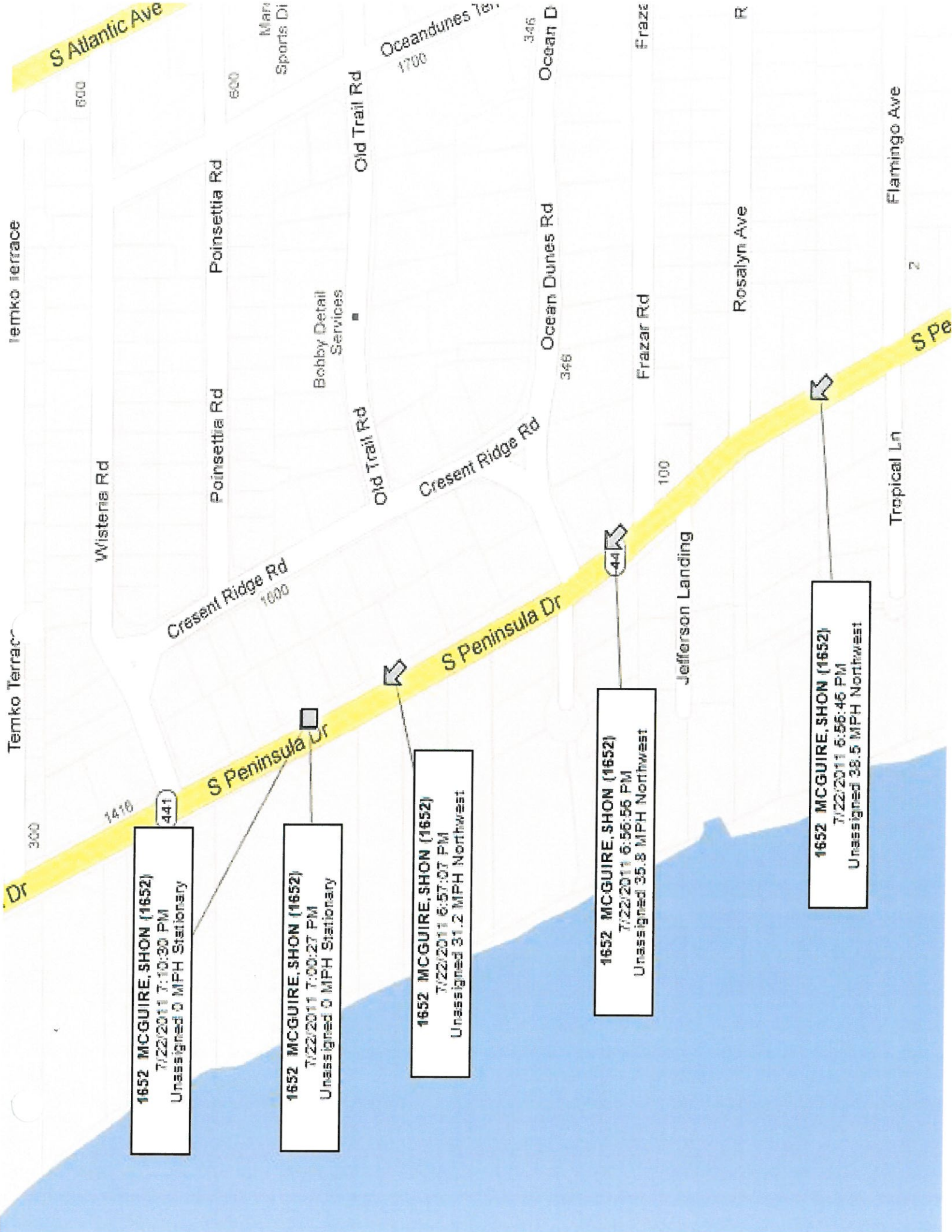

1652 MCGUIRE, SHON (1652)
7/22/2011 7:10:30 PM
Unassigned 0 MPH Stationary

1652 MCGUIRE, SHON (1652)
7/22/2011 7:00:27 PM
Unassigned 0 MPH Stationary

1652 MCGUIRE, SHON (1652)
7/22/2011 6:57:07 PM
Unassigned 31.2 MPH Northwest

1652 MCGUIRE, SHON (1652)
7/22/2011 6:56:56 PM
Unassigned 35.8 MPH Northwest

1652 MCGUIRE, SHON (1652)
7/22/2011 6:56:46 PM
Unassigned 38.5 MPH Northwest

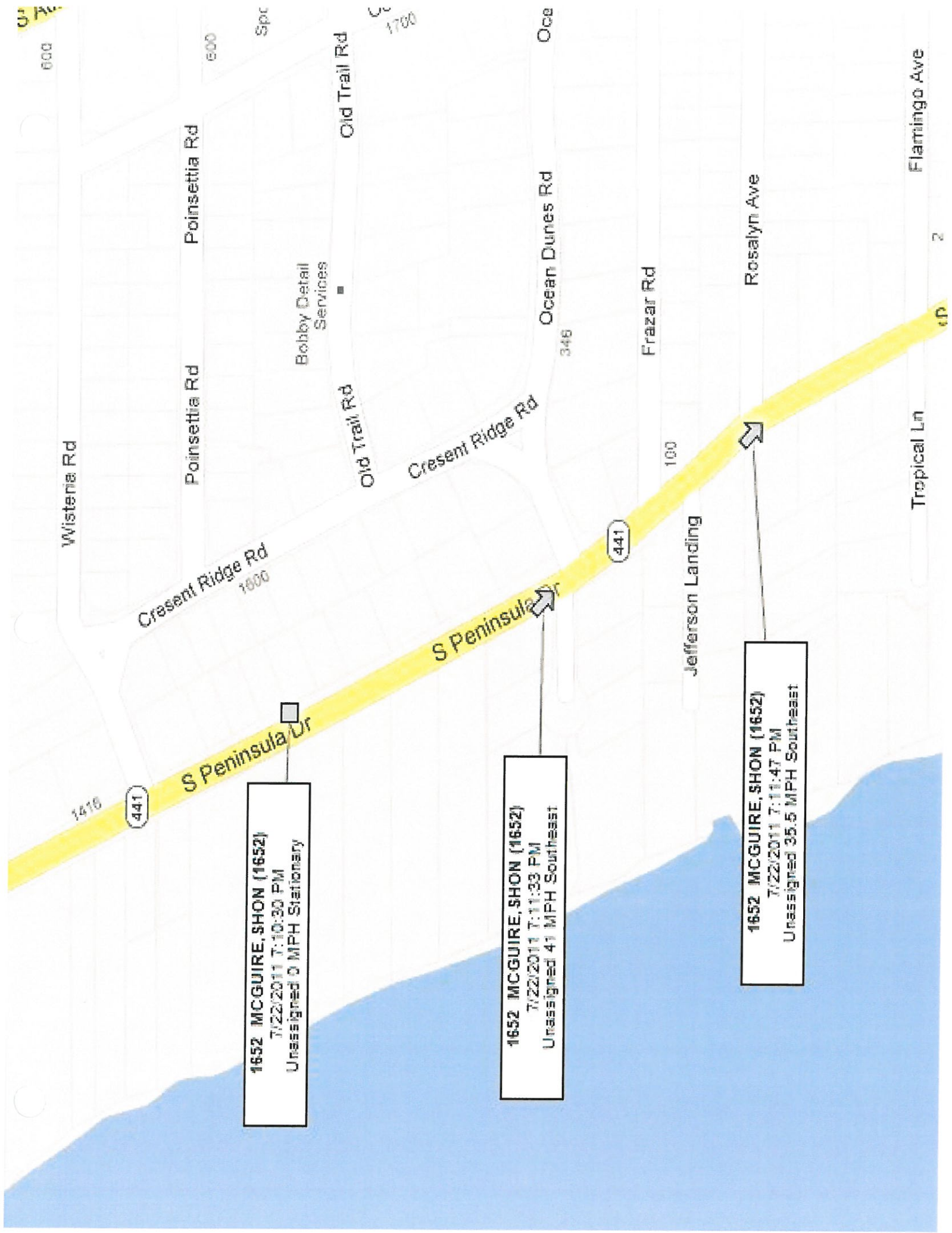

1652 MCGUIRE, SHON (1652)
7/22/2011 7:10:30 PM
Unassigned 0 MPH Stationary

1652 MCGUIRE, SHON (1652)
7/22/2011 7:11:33 PM
Unassigned 41 MPH Southeast

1652 MCGUIRE, SHON (1652)
7/22/2011 7:11:47 PM
Unassigned 35.5 MPH Southeast

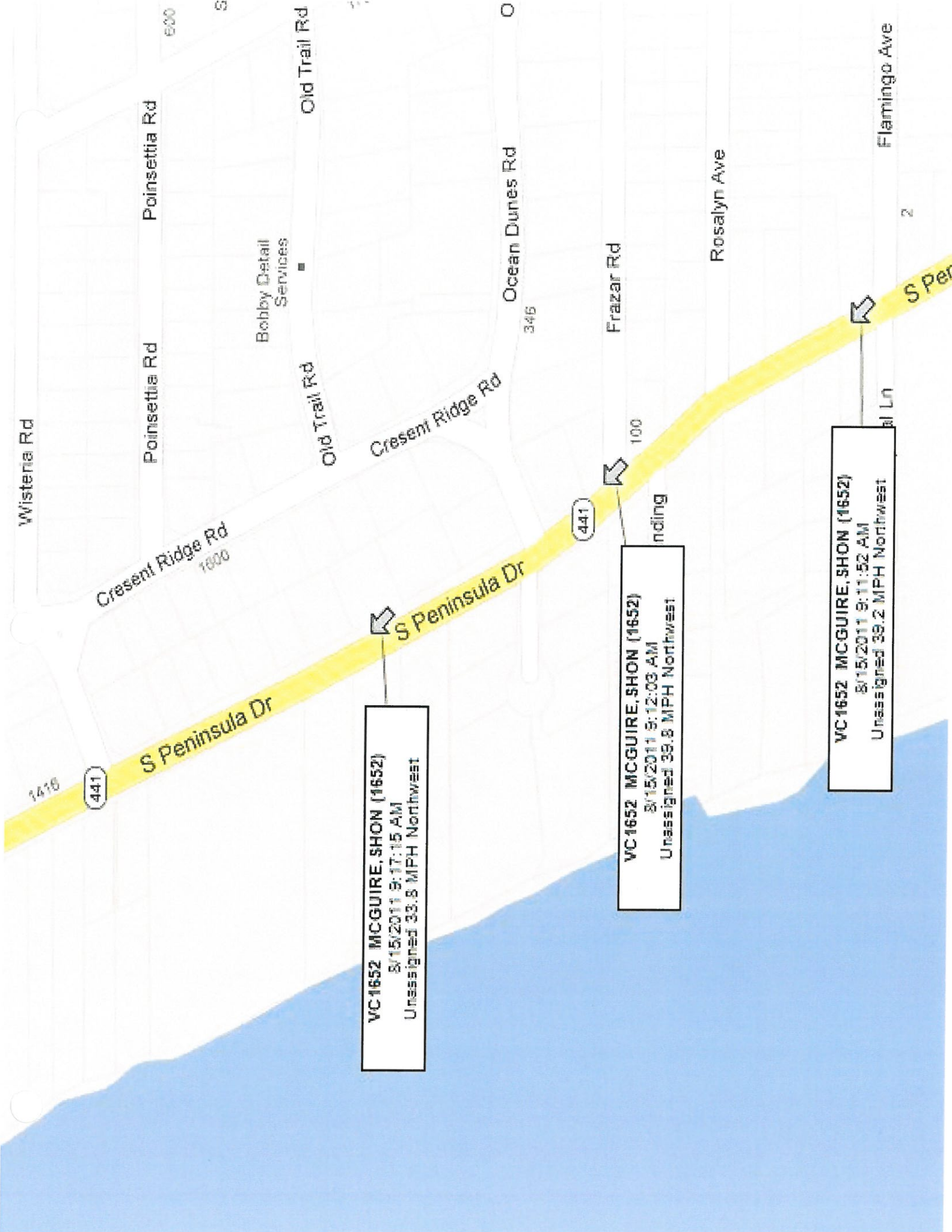

VC-1652 MCGUIRE, SHON (1652)
8/15/2011 9:17:15 AM
Unassigned 33.8 MPH Northwest

VC-1652 MCGUIRE, SHON (1652)
8/15/2011 9:12:03 AM
Unassigned 39.8 MPH Northwest

VC-1652 MCGUIRE, SHON (1652)
8/15/2011 9:11:52 AM
Unassigned 39.2 MPH Northwest

Wisteria Rd

Crescent Ridge Rd
1800

Poinsettia Rd

600

S

Bobby Detail Services

Old Trail Rd

Old Trail Rd

Crescent Ridge Rd

Ocean Dunes Rd

345

441

Frazar Rd

100

ending

Rosalyn Ave

al Ln

Flamingo Ave

2

S Per

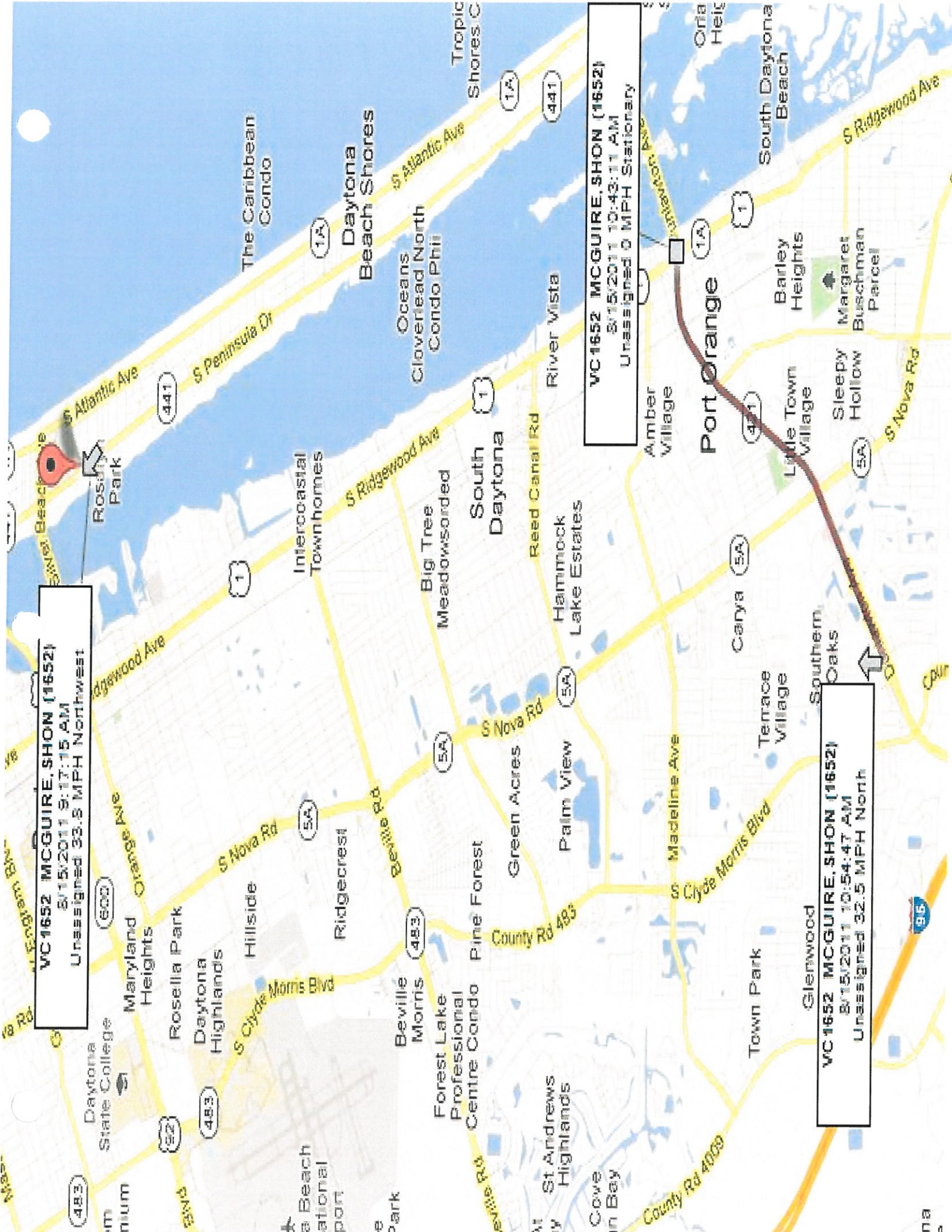

VC1652 MCGUIRE, SHON (1652)
8/15/2011 9:17:15 AM
Unassigned 33.5 MPH Northwest

VC1652 MCGUIRE, SHON (1652)
8/15/2011 10:43:11 AM
Unassigned 0 MPH Stationary

VC1652 MCGUIRE, SHON (1652)
8/15/2011 10:54:47 AM
Unassigned 32.5 MPH North

Detailed History for Unit VC1652 Between 08/15/2011 00:00 And 08/15/2011 23:59 [Detail](#)

09:01:35 *LOGON [Operator:1652](#) [OperNames:MCGUIRE, SHON](#) [MobileId:M263](#)
09:01:35 *OPON [Operators:1652](#) [OperNames:MCGUIRE, SHON](#)
09:01:36 -AVLCNT
12:57:18 *RFT [Plate:N913YP](#)
13:00:24 *OPOFF
13:00:24 *LOGOFF

Speed	Direction	Name	PID
35.8	325.8 Northwest	MCGUIRE,SHON	1652
31.2	335.81 Northwest	MCGUIRE,SHON	1652
0	210.66 Stationary	MCGUIRE,SHON	1652
0	259.65 Stationary	MCGUIRE,SHON	1652
0.2	127.88 Stationary	MCGUIRE,SHON	1652
0.1	246.35 Stationary	MCGUIRE,SHON	1652
41	152.84 Southeast	MCGUIRE,SHON	1652
39.8	322.38 Northwest	MCGUIRE,SHON	1652
33.8	334.25 Northwest	MCGUIRE,SHON	1652
33.8	334.25 Northwest	MCGUIRE,SHON	1652

10 min

Unit ID	Date - Time	Agency	Service	LAT	Long	Status
1652	7/22/11 18:56	VP	P	29.205692	-81.002448	Unassigned
1652	7/22/11 18:57	VP	P	29.207048	-81.003268	Unassigned
1652	7/22/11 19:00	VP	P	[REDACTED]	[REDACTED]	Unassigned
1652	7/22/11 19:03	VP	P	29.20756	-81.00351	Unassigned
1652	7/22/11 19:07	VP	P	29.207572	-81.003533	Unassigned
1652	7/22/11 19:10	VP	P	29.207567	-81.003547	Unassigned
1652	7/22/11 19:11	VP	P	29.206117	-81.00291	Unassigned
VC1652	8/15/11 9:12	VP	P	29.205517	-81.002282	Unassigned
VC1652	8/15/11 9:12	VP	P	29.20683	-81.00314	Unassigned
VC1652	8/15/11 9:17	VP	P	29.20683	-81.00314	Unassigned



Output for: 2405

Detailed History for Unit 1652 Between 07/22/2011 00:00 And 07/22/2011 23:59

18:51:08 *LOGON	1652	MCGUIRE,SHON	M263
18:51:08 *OPON	1652	MCGUIRE,SHON	
18:51:10 -AVLCNT			
20:29:09 *OPOFF			
20:29:09 *LOGOFF			

Eagan, Erik

From: Melissa Murphy [melissa.murphy@cobbcole.com]
Sent: Friday, March 16, 2012 9:24 AM
To: Jones, Nancye
Subject: Cara Gittner

Nancye,

As a follow-up to our conversation yesterday, I spoke with Ms. Gittner and she is declining to be interviewed as a witness. Thank you for your professional courtesy as always and please let me know if I can ever assist you in the future.

Best Regards,



Melissa Murphy
Florida Bar No. 70071
150 Magnolia Ave.
P.O. Box 2491
Daytona Beach, Florida 32115-2491
Direct 386-254-6343
Fax 386-944-0960
www.CobbCole.com

Units on between: 07/15/2011 - 08/20/2011 (Responses: 38)

Operators:1652

Output for: 2273

[Click on heading to change sort order.](#)

Unit	Logon	Logoff	Darea	Operators	Name	Vehicle	Radio	Relog
1B34	07/15/2011 05:44	07/15/2011 18:15		1652	MCGUIRE,SHON			N
1B34	07/16/2011 05:44	07/16/2011 18:59		1652	MCGUIRE,SHON			N
1B34	07/17/2011 05:47	07/17/2011 18:18		1652	MCGUIRE,SHON			N
1652	07/19/2011 12:43	07/19/2011 14:20		1652	MCGUIRE,SHON			N
1652	07/19/2011 17:49	07/19/2011 20:44		1652	MCGUIRE,SHON			N
1B34	07/20/2011 05:43	07/20/2011 18:24		1652	MCGUIRE,SHON			N
1B34	07/21/2011 05:38	07/21/2011 18:18		1652	MCGUIRE,SHON			N
1652	07/22/2011 18:51	07/22/2011 20:29		1652	MCGUIRE,SHON			N
1B34	07/25/2011 05:41	07/25/2011 06:27		1652	MCGUIRE,SHON			N
1B34	07/25/2011 06:27	07/25/2011 10:43	03	1652 7835	MCGUIRE,SHON; MCDANIEL, KYLE			Y
1B34	07/25/2011 10:45	07/25/2011 18:03		1652	MCGUIRE,SHON MCDANIEL, KYLE			N
1B34	07/26/2011 05:40	07/26/2011 06:54		1652	MCGUIRE,SHON			N
1B34	07/26/2011 06:54	07/26/2011 18:09	03	1652 7835	MCGUIRE,SHON; MCDANIEL, KYLE			Y
1652	07/28/2011 07:10	07/28/2011 16:35		1652	MCGUIRE,SHON			N
1B34	07/29/2011 05:43	07/29/2011 18:17		1652	MCGUIRE,SHON MCDANIEL, KYLE			N
1B34	07/30/2011 05:46	07/30/2011 18:13		1652	MCGUIRE,SHON MCDANIEL, KYLE			N
1B34	07/31/2011 05:40	07/31/2011 19:21		1652	MCGUIRE,SHON MCDANIEL, KYLE			N
1B34	08/03/2011 05:40	08/03/2011 18:50		1652	MCGUIRE,SHON MCDANIEL, KYLE			N
1B34	08/04/2011 05:45	08/04/2011 19:08		1652	MCGUIRE,SHON MCDANIEL, KYLE			N
1D34	08/07/2011 05:45	08/07/2011 06:16		1652	MCGUIRE,SHON			N
1D34	08/07/2011 06:16	08/07/2011 18:33	03	1652 7829	MCGUIRE,SHON; HILL, KELLY			Y

<u>1B34</u>	08/08/2011 05:34	08/08/2011 19:10		1652	MCGUIRE,SHON MCDANIEL, KYLE			N
<u>1B34</u>	08/09/2011 05:42	08/09/2011 18:15		1652	MCGUIRE,SHON MCDANIEL, KYLE			N
<u>VC1652</u>	08/09/2011 18:54	08/09/2011 20:12		1652	MCGUIRE,SHON			N
<u>VC1652</u>	08/10/2011 07:14	08/10/2011 16:36		1652	MCGUIRE,SHON			N
<u>1B34</u>	08/12/2011 05:29	08/12/2011 06:15		1652	MCGUIRE,SHON			N
<u>1B34</u>	08/12/2011 06:15	08/12/2011 18:19	03	1652 7841	MCGUIRE,SHON; SYLVESTER, DAVID			Y
<u>1B34</u>	08/13/2011 05:43	08/13/2011 07:00		1652	MCGUIRE,SHON			N
<u>1B34</u>	08/13/2011 07:00	08/13/2011 18:11	03	1652 7841	MCGUIRE,SHON; SYLVESTER, DAVID			Y
<u>1B34</u>	08/14/2011 05:50	08/14/2011 05:58	03	1652	MCGUIRE,SHON			N
<u>1B34</u>	08/14/2011 05:58	08/14/2011 07:02		1652	MCGUIRE,SHON			Y
<u>1B34</u>	08/14/2011 07:02	08/14/2011 18:10	03	1652 7841	MCGUIRE,SHON; SYLVESTER, DAVID			Y
<u>VC1652</u>	08/15/2011 09:01	08/15/2011 13:00		1652	MCGUIRE,SHON			N
<u>1B34</u>	08/18/2011 05:39	08/18/2011 07:01		1652	MCGUIRE,SHON			N
<u>1B34</u>	08/18/2011 07:01	08/18/2011 19:07	03	1652 7841	MCGUIRE,SHON; SYLVESTER, DAVID			Y
<u>VC1652</u>	08/19/2011 12:37	08/19/2011 12:48		1652	MCGUIRE,SHON			N
<u>1D33</u>	08/20/2011 05:40	08/20/2011 17:54		1652	MCGUIRE,SHON			N
<u>1D33</u>	08/20/2011 17:54	08/20/2011 18:00		1652	MCGUIRE,SHON			N

Volusia County Sheriff's Office

Discipline History Shon McGuire

Incident Date	Case #	Case Type:	Status	Report #	Allegation	Violation	Finding	Action
McGuire, Shon D								
1652								
02/02/2004	SD-04-026	Supervisor Discipline	Closed	04003773	26.2.95 Careless Handling of Equip &		Sustained	Counseling
03/22/2006	CC-06-011	Citizen Complaint	Closed		26.2.61 Harassment	Unsatisfactory Performance of Duties Backing Accident	Not Sustained	None
04/19/2006	SD-06-069	Supervisor Discipline	Closed	06013347	26.2.96 Careless Handling of Equip & Veh		Sustained	Counseling
12/07/2007	SD-08-039	Supervisor Discipline	Closed	07042140	26.2.098 Careless Handling Equip & Veh	Traffic Accident	Sustained	Written Reprimand
08/08/2008	CC-08-043	Citizen Complaint	Closed	08026723	26.2.131 General Proficiency	Call Handling	Unfounded	None
03/03/2010	SD-10-066	Supervisor Discipline	Closed	10-6506	26.2.043 Search of an Arrested Person	Job Knowledge and Performance	Sustained	Counseling
07/26/2010	CC-10-027	Citizen Complaint	Closed	1023069	26.2.131 General Proficiency	Job Knowledge and Performance	Unfounded	None
01/17/2012	SD-12-032	Supervisor Discipline	Closed	12-1623	26.2.134 Knowledge of Policy & Procedure	Prisoner Property	Sustained	Written Reprimand
03/09/2012	IA-12-003	IA Investigation	Open					
Totals:				9				

OPERATOR 1652 – McGuire, Shon

AVL (Automated Vehicle Locator) ACTIVITY SAMPLING

DATE	UNIT ID	LOGON TIME	AVLCNT TIME
04-14-2011	1B34	1940	1940
04-17-2011	1652	2222	2224
04-22-2011	1652	1016	1016
05-02-2011	1B34	0531	0538
05-04-2011	1652	1443	1446
05-10-2011	1652	0729	0729
05-14-2011	1652	1108	1108
05-14-2011	1X36	1545	1545
06-22-2011	1652	1240	N/A
06-22-2011	1652	1341	N/A
07-01-2011	1652	0548	0551
07-04-2011	1652	1145	1146
07-05-2011	1652	0713	1111
07-07-2011	1652	1846	1847
07-10-2011	1652	1350	1351
07-12-2011	1B34	0544	0544
07-13-2011	1652	0726	0726
07-20-2011	1B34	0543	0543
07-21-2011	1B34	0538	0539
07-22-2011	1652	1851	1851
07-25-2011	1B34	0541	0556
07-25-2011	1B34	1045	1046
07-26-2011	1B34	0540	0540
07-28-2011	1652	0710	0710
07-29-2011	1B34	0543	N/A
07-30-2011	1B34	0546	0546
07-31-2011	1B34	0540	0540
08-07-2011	1D34	0545	0545
08-09-2011	VC1652	1854	1855
08-10-2011	VC1652	0714	0714
08-13-2011	1B34	0543	0543
08-14-2011	1B34	0550	N/A
08-14-2011	1B34	0558	0601
08-15-2011	VC1652	0901	0901
08-18-2011	1B34	0539	0539
08-23-2011	1B34	1734	N/A
08-23-2011	1B34	1735	N/A
08-24-2011	VC1652	0719	0719
08-26-2011	1B34	0537	N/A

08-26-2011	1B34	0540	0540
08-26-2011	VC1652	1847	1848
09-09-2011	1C34	0657	N/A
10-16-2011	VC1652	1406	1407
10-17-2011	VC1652	0720	N/A
10-17-2011	VC1652	0758	0800
10-19-2011	VC1652	1609	1611
10-23-2011	VC1652	0544	0544
10-23-2011	VC1652	0752	N/A
10-23-2011	VC1652	0806	N/A
10-23-2011	VC1652	1300	1300
10-26-2011	VC1652	0537	0537
10-27-2011	VC1652	1302	N/A
10-27-2011	VC1652	1746	1746
10-28-2011	VC1652	0947	0950
11-06-2011	VC1652	2343	N/A
11-07-2011	VC1652	2346	2346

 - AVL Not Connected

 - AVL Late Connection

Output for: 2273

Detailed History for Unit **1B34** Between 04/14/2011 19:40 And 04/15/2011 06:28 Detail

19:40:25 *LOGON Operator:1652 OperNames:MCGUIRE,SHON MobileId:M263
 19:40:25 *OPON Operators:1652 OperNames:MCGUIRE,SHON
19:40:34 -AVLCNT
 20:26:17 *RFT Plate:[F323BC](#)
 20:26:29 *RFT Plate:[F323RC](#)
 20:27:51 *RFT Plate:[5121GX](#)
 20:29:04 *RFT Plate:[6262ACH](#)
 20:29:33 *RFT Plate:[6262ACH/PC/GA/2011](#)

20:33:34 BACKUP [#P111042047](#) UnitID:1B33 Type:911CK CallLoc:109 ASTOR ST, DB Location:109 ASTOR ST, DB
 20:34:14 *ENRTE
 20:36:39 ONSCN
 20:43:49 OK
 20:56:22 CLEAR Type:42

21:08:30 DISPOS [#P111042126](#) Type:TS Location:FLOMICH ST/SAN JOSE BLVD, DB Plate:[J66PKK](#)
 21:08:30 -PRIU
 21:08:36 LOGM Message:[011104150108001012](#) MessageType:Text Received:04/14/2011 21:08:24 Comment:28
 21:09:57 *RFT OLN:S532205738631
 21:10:53 *CLEAR Type:TS Dispo:NR DispoLevel:10

21:11:56 *RFT Plate:[Q874DN](#)

21:13:09 BACKUP [#P111042134](#) UnitID:1B33 Type:TS CallLoc:GOLF AV/S NOVA RD, HH Location:GOLF AV/S NOVA RD, HH
 21:13:10 ONSCN
 21:17:07 *CLEAR Type:TS

21:23:53 *RFT Plate:[AB93074/PC/AZ/2011](#)

21:26:31 *DISPOS [#P111042165](#) Type:EP Location:700 S NOVA RD, OB
 21:26:31 -PRIU
 21:29:57 *CLEAR Type:EP Dispo:NR DispoLevel:10

21:55:26 BACKUP [#P111042218](#) UnitID:1B33 Type:22 CallLoc:STEWART-MARCHMAN BLDG E, DB Location:STEWART-MARCHMAN BLDG E, DB
 22:11:44 PRMPT Comment:Preempted and dispatched to call [#P111042255](#)

22:11:44 DISP [#P111042255](#) Type:22D CallLoc:1335 FLEMING AV #160 OB, OB
 22:11:44 -PRIU
 22:28:09 ONSCN
 22:30:22 OK
 22:30:35 RFT Name:PRATT,NICHOLAS R Sex:M DOB:19660907
 22:30:54 RFT Name:CHEVRETTE,ANTONINETTE M Sex:F DOB:19621207
 22:34:36 LOGM Message:[011104150234002509](#) MessageType:Text Received:04/14/2011 22:31:28 Comment:PRATT
 22:34:58 LOGM Message:[011104150234002518](#) MessageType:Text Received:04/14/2011 22:31:30 Comment:CHEVERETTE
 22:35:25 INV Type:INVP Priority:1 Name:CHEVRETTE,ANTOINETTE MARIE Race:W Sex:F

22:35:43 INV **DOB:12/07/1962 Age:48 Category:P**
Type:INVP Priority:1 Name:PRATT,NICHOLAS ROBERT Race:W Sex:M DOB:09/07/1966
Age:44 Category:P
 22:36:38 CLEAR **Type:22D Dispo:NR DispoLevel:10**

22:45:09 *RFT **Plate:956WWY**

22:59:03 DISP **#P111042317 Type:ESCORT CallLoc:1741 MONTGOMERY DR, DB**
 22:59:03 -PRIU
 23:06:11 *ENRTE
 23:09:23 *ONSCN
 23:14:03 *MISC **Comment:FEMALE GOT HER THINGS, LEFT PRIOR TO MY ARRIVAL, CONTACT**
MADE WITH FEMALE
 23:15:33 *CLEAR **Type:ESCORT Dispo:NR DispoLevel:10**

23:17:54 DISPOS **#P111042342 Type:SS Location:SAN JOSE BLVD/FLOMICH ST, DB**
 23:17:54 -PRIU
 23:18:43 *RFT **Name:TAYLOR,TINA M Sex:F DOB:19620816**
 23:20:41 *RFT **OLN:T460800627960**
 23:21:46 *RFT **Name:BRAINARD,SAMANTHA J Sex:F DOB:19861123**
 23:33:17 OK
 23:44:15 MISC **Comment:10-15 ADULT FEMALE S/31**
 23:49:26 *CASE **Case#:VP110011313**
 [04/15/2011]
 00:20:18 CLEAR **Type:SS Dispo:INC DispoLevel:0 Comment:NTA**

00:40:23 DISP **#P111050063 Type:22 CallLoc:1624 MONTGOMERY DR, DB**
 00:40:23 -PRIU
 00:44:47 CLEAR **Type:22**

01:17:28 *RFT **Plate:M056NP**
 01:22:29 *RFT **Plate:NDN0WL**

01:56:13 *DISPOS **#P111050132 Type:EP Location:1200 FLOMICH ST, DB**
 01:56:13 -PRIU
 01:59:41 *RFT **Plate:AAYL55**
 02:03:33 OK
 02:03:43 *CLEAR **Type:EP Dispo:NR DispoLevel:10**

02:05:06 *RFT **Plate:ATY6001/PC/GA/2011**
 02:17:04 *RFT **Plate:288XXK**

02:23:56 DISPOS **#P111050153 Type:TS Location:FLEMING AV/S NOVA RD, OB Plate:AMU0045**
 02:23:56 -PRIU
 02:24:16 LOGM **Message:011104150624005497 MessageType:Text Received:04/15/2011 02:23:50**
Comment:LOGM
 02:25:18 *RFT **OLN:P362400912130**
 02:29:59 OK
 02:30:51 *RFT **Plate:EXG5906/PC/OH/2011**
 02:31:26 *CLEAR **Type:TS Dispo:NR DispoLevel:10**

02:34:10 *RFT **Plate:Q866PU**

02:35:12 DISPOS **#P111050163 Type:TS Location:15TH ST/N NOVA RD, HH Plate:Q866PU**

02:35:12 -PRIU
02:35:21 MISC **Comment:**AT THE MASON BELL CAR LOT
02:35:36 LOGM **Message:**[011104150635005686](#) **MessageType:**Text **Received:**04/15/2011 02:35:04
Comment:LOGM
02:36:05 CLOS **Location:**MASON AV MOTORS, HH **LocDesc:**at 1750 N NOVA RD, HH **LocCross:**btwn
WALKER ST and 15TH ST
02:36:57 *RFT **OLN:**I220104591750
02:38:28 *CLEAR **Type:**TS **Dispo:**INC **DispoLevel:**0

03:02:53 OK **#P111050182** **Comment:**ADVISED CODE 4
03:03:00 DISPOS **Type:**TS **Location:**8TH ST/N NOVA RD, DB **Plate:**[M056NP](#)
03:03:00 -PRIU
03:03:26 LOGM **Message:**[011104150703006139](#) **MessageType:**Text **Received:**04/15/2011 03:03:00
Comment:LOGM
03:03:32 *RFT **Name:**YIANNOPOULOS,KRISTINA **Sex:**F **DOB:**19811113
03:09:08 *CLEAR **Type:**TS **Dispo:**NR **DispoLevel:**10

03:09:57 *RFT **Plate:**[088XXA](#)

03:41:36 *DISPOS **#P111050216** **Type:**EP **Location:**1376 N NOVA RD, DB
03:41:36 -PRIU
03:52:11 OK
04:07:45 *CLEAR **Type:**EP **Dispo:**NR **DispoLevel:**10

04:22:22 DISPOS **#P111050245** **Type:**TS **Location:**8TH ST/N NOVA RD, DB **Plate:**[468XXC](#)
04:22:22 -PRIU
04:22:48 LOGM **Message:**[011104150822006667](#) **MessageType:**Text **Received:**04/15/2011 04:22:14
Comment:LOGM
04:24:17 *RFT **OLN:**M242113876640
04:28:34 OK
04:31:28 CLEAR **Type:**TS **Dispo:**NR **DispoLevel:**10

05:11:49 DISP **#P111050270** **Type:**40 **CallLoc:**743 TIMOTHY ST, OB
05:11:49 -PRIU
05:20:17 *ENRTE
05:39:00 *ONSCN
05:39:41 OK
05:41:18 MISC **Plate:**[2KK055/PC/OK/2011](#) **Comment:**WHI GMC
05:41:20 MISC **Plate:**[J526SF](#) **Comment:**BLK ISUZU
05:41:41 LOGM **Message:**[011104150941007147](#) **MessageType:**Text **Received:**04/15/2011 05:41:24
Comment:LOGM
05:42:01 LOGM **Message:**[011104150942007149](#) **MessageType:**Text **Received:**04/15/2011 05:41:39
Comment:LOGM
05:42:17 LOGM **Message:**[011104150942007152](#) **MessageType:**Text **Received:**04/15/2011 05:41:58
Comment:LOGM
05:42:58 CASE **Case#:**VP110011322
06:00:57 CLEAR **Type:**40 **Dispo:**NR **DispoLevel:**10

06:28:38 *OPOFF
06:28:38 *LOGOFF

Output for: 2273

Detailed History for Unit 1652 Between 04/17/2011 22:22 And 04/17/2011 23:41 Detail

22:22:02 *LOGON Operator:1652 OperNames:MCGUIRE,SHON MobileId:M263

22:22:02 *OPON Operators:1652 OperNames:MCGUIRE,SHON

22:24:19 -AVLCNT

23:41:11 *OPOFF

23:41:11 *LOGOFF

Output for: 2273

Detailed History for Unit 1652 Between 04/22/2011 10:16 And 04/22/2011 11:44 [Detail](#)

10:16:22 *LOGON Operator:1652 OperNames:MCGUIRE,SHON MobileId:M263

10:16:22 *OPON Operators:1652 OperNames:MCGUIRE,SHON

10:16:29 -AVLCNT

11:44:25 *OPOFF

11:44:25 *LOGOFF

Output for: 2273

Detailed History for Unit **1B34** Between 05/02/2011 05:31 And 05/02/2011 18:09 Detail

05:31:41 *LOGON Operator:1652 OperNames:MCGUIRE,SHON MobileId:M263
05:31:41 *OPON Operators:1652 OperNames:MCGUIRE,SHON
05:38:34 -AVLCNT
05:43:31 *OUT Location:D3, HH Type:OUT Darea:HH RD:8115 TypeDesc:Out LocDesc:at 999 3RD ST, HH
 LocCross:btwn EDDIE AV and N NOVA RD Priority:4 Response:1PAT Agency:HH
 Zone:HH03 Map:20 A3 LocType:C
05:57:23 CLOS Location:D3
05:57:36 OK
06:47:12 *CLEAR Type:OUT Dispo:NR DispoLevel:10
07:05:29 *RFT Plate:L093IQ

07:06:54 DISPOS #P111220314 Type:TS Location:FLOMICH ST/N NOVA RD, HH Plate:L093IQ
07:06:54 -PRIU
07:07:08 LOGM Message:011105021107006831 MessageType:Text Received:05/02/2011 07:06:54 Comment:90
 SUBARU
07:07:12 CLOS Location:1905 N NOVA RD, HH LocDesc:btwn FLOMICH ST and OLD KINGS RD
07:07:28 RFT OLN:M460791628400
07:07:57 LOGM Message:011105021107006851 MessageType:Text Received:05/02/2011 07:07:29 Comment:R/O
 * MILLER - FL DL * VALID - 29P 10-54
07:08:29 *RFT OLN:M460791628400
07:09:38 *CLEAR Type:TS Dispo:NR DispoLevel:10

07:11:30 DISP #P111220311 Type:911CK CallLoc:915 DERBYSHIRE RD, DB
07:11:30 -PRIU
07:12:33 *ENRTE
07:18:36 ONSCN
07:20:13 *CLEAR Type:911CK Dispo:NR DispoLevel:10

07:41:36 *RFT Plate:3077HG

07:42:49 *DISPOS #P111220373 Type:EP Location:ORMOND BREEZE MHP, OB
07:42:49 -PRIU
07:58:09 *CLEAR Type:EP Dispo:NR DispoLevel:10

08:10:03 *DISPOS #P111220418 Type:EP Location:1200 FLOMICH ST, DB
08:10:03 -PRIU
08:15:31 *CLEAR Type:EP Dispo:NR DispoLevel:10

08:32:07 *OUT Location:B1 Type:OUT Darea:03 TypeDesc:Out Priority:4 Response:1PAT Agency:VP
 LocType:O
08:35:29 CHANGE Location:B1, DB Darea:03 RD:107 Agency:VP Zone:35 Map:32 A2
08:35:33 OK
09:26:16 *CLEAR Type:OUT Dispo:NR DispoLevel:10

09:26:52 BACKUP #P111220520 UnitID:1B30 Type:22D CallLoc:110 PINE CREEK CT, OB Location:110 PINE
 CREEK CT, OB
09:28:14 *ENRTE
09:34:06 PRMPT

09:34:35 DISP #P111220542 Type:THC CallLoc:1335 FLEMING AV #26, OB

09:34:35 -PRIU

09:39:55 *CLEAR Type:THC Dispo:NR DispoLevel:10

10:30:25 *DISPOS #P111220658 Type:EP Location:700 S NOVA RD, OB

10:30:25 -PRIU

10:30:38 OK

10:34:58 *CLEAR Type:EP Dispo:NR DispoLevel:10

10:35:07 *RFT Plate:3077HG

10:35:30 DISPOS #P111220672 Type:TS Location:1400 BLK HAND AV, OB Plate:3077HG

10:35:30 -PRIU

10:35:50 LOGM Message:011105021435009085 MessageType:Text Received:05/02/2011 10:35:29 Comment:90
BUICK 2D ... EXP'D 02-20-2011

10:38:04 *RFT OLN:B652432855600

10:42:38 OK

10:46:05 *CLEAR Type:TS Dispo:NR DispoLevel:10

10:48:51 DISP #P111220698 Type:911CK CallLoc:1573 AIRPORT RD, OB

10:48:51 -PRIU

11:01:15 ONSCN

11:04:07 *MISC Comment:RESIDENT WAS TRYING TO CALL 252-4911 FOR HER MOTHER WHO
NEEDED MEDICAL ATTENTION AT ANOTHER LOCATION. CODE 4 HERE

11:05:16 *CLEAR Type:911CK Dispo:NR DispoLevel:10

11:16:55 *RFT Plate:499HHC

11:22:14 *RFT Plate:536IOQ

11:35:26 DISP #P111220792 Type:ESCORT CallLoc:1407 AVENUE C, OB Location:1106 AVENUE G, OB

11:35:26 -PRIU

11:36:49 CHGLOC Location:1400 BLK AV C, OB LocDesc:btwn FLEMING AV and PINE DR

11:40:29 *ONSCN

11:44:31 *CLEAR Type:ESCORT Dispo:NR DispoLevel:10

11:46:14 *DISPOS #P111220808 Type:EP Location:HOLIDAY VILLAGE MHP, OB

11:46:14 -PRIU

11:49:16 *RFT Plate:111IQN

11:49:59 *RFT Plate:K315WY

11:54:26 *RFT Plate:P600KH

11:54:37 *CLEAR Type:EP Dispo:NR DispoLevel:10

12:48:13 *OUT Location:125 E ORANGE AV, DB Type:OUT Darea:DBE RD:9069 TypeDesc:Out
LocDesc:btwn CITY ISLAND PKWY and ORANGE AV BRIDGE Priority:4 Response:1PAT
Agency:DB Zone:DB57 Map:21 C1 LocType:S Comment:COURT

12:48:25 REDIR Darea:03 RD:9069 Agency:DB

12:50:27 OK

13:55:42 *CLEAR Type:OUT Dispo:NR DispoLevel:10

14:39:55 *DISPOS #P111221104 Type:EP Location:700 S NOVA RD, OB

14:39:55 -PRIU

14:47:50 *CLEAR Type:EP Dispo:NR DispoLevel:10

15:19:22 *RFT Plate:803IMW

15:22:01 *RFT Plate:1619HK

15:23:01 *RFT **Name:**BRYANT,ERIC ALLEN **Sex:**M **DOB:**19650224
15:30:15 *RFT **Plate:**[ICA934](#)
15:35:44 *RFT **Plate:**[P915KI](#)
15:36:59 *RFT **Plate:**[025VNC](#)

16:01:45 DISPOS **#**[P111221252](#) **Type:**FLAG **Location:**VALENCIA AV/FLOMICH ST, DB
16:01:45 -PRIU
16:02:33 CLOS
16:07:31 *RFT **Name:**STARK,BONNIE JEAN **Sex:**F **DOB:**19790512
16:08:52 *RFT **Name:**RYAN,CODY VINTON **Sex:**M **DOB:**19851211
16:09:26 *RFT **OLN:**29857635
16:12:03 OK
16:58:06 *CLEAR **Type:**21B **Dispo:**NR **DispoLevel:**10

17:29:15 *RFT **Plate:**[L889IM](#)
17:29:39 *RFT **Plate:**[W323LS](#)
17:30:12 *RFT **Name:**SISNEROS,LINDA ARLENE **Sex:**F **DOB:**19480722
17:37:23 *RFT **Plate:**[AJX540](#)
18:04:07 *RFT **Plate:**[E913PP](#)
18:06:55 *RFT **Plate:**[F345RC](#)
18:09:35 *OPOFF
18:09:35 *LOGOFF

Output for: 2273

Detailed History for Unit 1652 Between 05/04/2011 14:43 And 05/04/2011 16:27 [Detail](#)

14:43:46 *LOGON Operator:1652 OperNames:MCGUIRE,SHON MobileId:M263

14:43:46 *OPON Operators:1652 OperNames:MCGUIRE,SHON

14:46:18 -AVLCNT

16:27:52 *OPOFF

16:27:52 *LOGOFF

Output for: 2273

Detailed History for Unit 1652 Between 05/10/2011 07:29 And 05/10/2011 16:26 Detail

07:29:29 *LOGON Operator:1652 OperNames:MCGUIRE,SHON MobileId:M263

07:29:29 *OPON Operators:1652 OperNames:MCGUIRE,SHON

07:29:31 -AVLCNT

07:53:09 *OUT Location:DELAND COURTHOUSE, DEL Type:OUT Darea:DL RD:8341 TypeDesc:Out
LocDesc:at 101 N ALABAMA AV, DEL LocCross:btwn E INDIANA AV and E RICH AV
Priority:4 Response:IPAT Agency:DL Zone:DL03 Map:44 C3 LocType:C

07:53:18 OK

16:10:48 *CLEAR Type:OUT Dispo:NR DispoLevel:10

16:26:03 *OPOFF

16:26:03 *LOGOFF

Output for: 2273

Detailed History for Unit 1652 Between 05/14/2011 11:08 And 05/14/2011 12:15 Detail

11:08:20 *LOGON Operator:1652 OperNames:MCGUIRE,SHON MobileId:M263

11:08:20 *OPON Operators:1652 OperNames:MCGUIRE,SHON

11:08:22 -AVLCNT

12:15:23 *OPOFF

12:15:23 *LOGOFF

Output for: 2273

Detailed History for Unit 1X36 Between 05/14/2011 15:45 And 05/15/2011 00:11 Detail**15:45:11 *LOGON** Operator:1652 OperNames:MCGUIRE,SHON MobileId:M263

15:45:11 *OPON Operators:1652 OperNames:MCGUIRE,SHON

15:45:22 -AVLCNT16:04:46 DISP [#P111341261](#) Type:13P CallLoc:3516 TORY CIR, OB

16:04:46 -PRIU

16:05:20 PRMPT

16:05:20 -HOLD

16:15:17 *DISPOS [#P111341284](#) Type:EP Location:1200 FLOMICH ST, DB

16:15:17 -PRIU

16:18:19 CLEAR Type:EP Dispo:NR DispoLevel:10

16:18:28 XDISP [#P111341283](#)

16:18:28 -PRIU

16:21:51 *ONSCN

16:23:24 *MISC Comment:10-96 TO HAND AVENUE

16:23:26 *CLEAR Type:13P Dispo:NR DispoLevel:10

16:27:30 *DISPOS [#P111341311](#) Type:17 Location:1406 AVE C,OB

16:27:30 -PRIU

16:39:09 *CLEAR Type:17 Dispo:NR DispoLevel:10

16:57:36 DISP [#P111341355](#) Type:39 CallLoc:113 COQUINA AV, OB

16:57:36 -PRIU

17:03:48 *MISC Comment:MOTHER WANTED US TO BE AWARE OF HIS SON'S BEHAVIOR. RP WAS ADVISED TO NOTIFY HER SON'S PROBATION OFFICER ON MONDAY MORNING.

17:04:07 CLEAR Type:39 Dispo:NR DispoLevel:10

17:04:09 BACKER [#P111341362](#) UnitID:1D33 Type:22 CallLoc:939 ROSALIE DR, DB Location:939 ROSALIE DR, DB

17:08:32 ONSCN

17:15:32 OK

17:22:00 *CLEAR Type:22

17:29:15 DISP [#P111341385](#) Type:41H CallLoc:125 SEMINOLE DR, OB

17:29:15 -PRIU

17:41:44 *MISC Comment:NOTHING CRIMINAL, AN EX-FRIEND IS POSTING COMMENTS ON FACEBOOK ABOUT THE SUBJECT HAVING STRETCH MARKS AND THINGS TO THAT NATURE.

17:42:03 *MISC Comment:THC'D

17:42:05 *CLEAR Type:41H Dispo:NR DispoLevel:10

18:15:24 *DISPOS [#P111341460](#) Type:EP Location:1634 N US HWY 1, OB

18:15:24 -PRIU

18:15:41 *RFT Plate:424HMG

18:16:37 *RFT Plate:118XVG

18:16:57 *RFT Plate:N871TL

18:17:26 *RFT Name:HAMPTON,TREVOR STEVEN Sex:M DOB:19810529

18:17:49 *RFT Plate:467YTL

18:18:01 *RFT Plate:[SEISMIC](#)
 18:18:09 *RFT Plate:[L987WW](#)
 18:18:37 *RFT Name:DAVIS,STEVEN MARSHALL Sex:M DOB:19721201
 18:19:46 *CLEAR Type:EP Dispo:NR DispoLevel:10

18:20:46 *DISPOS [#P111341469](#) Type:EP Location:SCOTTISH INN,OB

18:20:46 -PRIU

18:21:09 *RFT Plate:[AJKY79](#)

18:21:23 *RFT Plate:[106040](#)

18:21:34 *RFT Plate:[T302372](#)

18:21:44 *RFT Plate:[552WMS](#)

18:21:57 *RFT Plate:[254IYI](#)

18:22:20 *RFT Plate:[Y3AHZ](#)

18:23:03 *RFT Plate:[N359ML](#)

18:23:45 *RFT Plate:[CC4WC](#)

18:24:40 *RFT Plate:[B467WD](#)

18:25:26 *RFT Plate:[9681IF](#)

18:25:51 *RFT Name:SANDERS,RICHARD ALLEN Sex:M DOB:19890420

18:26:52 *RFT Name:BARRHO,CARRIE ANN Sex:F DOB:19700305

18:30:49 *CHGLOC Location:DAYS INN,OB

18:30:51 *ONSCN

18:31:10 *RFT Plate:[ABNS27](#)

18:31:24 *RFT Plate:[034WNE](#)

18:31:43 *RFT Plate:[YEOKO](#)

18:33:17 *RFT Name:HOOPER,DEREK TAYLOR Sex:M DOB:19840620

18:34:29 *CLEAR Type:EP Dispo:NR DispoLevel:10

18:45:56 DISPOS [#P111341508](#) Type:TS Location:OLD DIXIE HWY/N I-95, OB Plate:[N915CA](#)

18:45:56 -PRIU

18:46:02 LOGM Message:[011105142246018123](#) MessageType:Text Received:05/14/2011 18:45:54 Comment:28

18:48:14 *RFT Name:O520836724480

18:48:31 *RFT Name:O520836724480

18:49:28 OK

18:49:36 RFT OLN:O520836724480

18:50:33 LOGM Message:[011105142250018196](#) MessageType:Text Received:05/14/2011 18:49:42

Comment:OWEN,THOMAS

18:50:49 INV Type:INVP Priority:1 Name:OWENS,THOMAS RAY Race:W Sex:M DOB:12/08/1972 Age:38
 Category:P

18:52:00 *CLEAR Type:TS Dispo:NR DispoLevel:10

18:52:41 *DISPOS [#P111341526](#) Type:EP Location:ROSCOMMON PLAZA

18:52:41 -PRIU

18:53:39 *RFT Plate:[G466XS](#)

19:02:14 OK

19:02:44 CHANGE Location:ROSCOMMON DR/KILLARNEY DR, OB Darea:03 RD:318 Agency:VP Zone:32
 Map:2 A2

19:03:16 *CLEAR Type:EP Dispo:NR DispoLevel:10

19:15:05 DISPOS [#P111341557](#) Type:13 Location:OLD DIXI/JAMES ORMOND

19:15:05 -PRIU

19:15:48 MISC Plate:[656LVX](#) Comment:28

19:16:00 LOGM Message:[011105142316018615](#) MessageType:Text Received:05/14/2011 19:15:50 Comment:28

19:16:46 *RFT OLN:H655559553670

19:21:16 *CLEAR Type:13 Dispo:NR DispoLevel:10

19:48:59 *DISPOS [#P111341619](#) Type:EP Location:BICENTENNIAL PARK, OB
 19:48:59 -PRIU
 19:56:21 *CLEAR Type:EP Dispo:NR DispoLevel:10

20:36:17 BACKUP [#P111341700](#) UnitID:1X31 Type:33 CallLoc:29 ALAMANDA DR, OB Location:29
 ALAMANDA DR, OB
 20:42:08 CLOS Location:15 ALAMANDA DR, OB LocDesc:btwn EASTERLY DR and HIBISCUS DR
 Comment:10.25 WITH THE MALE
 20:43:32 OK
 20:50:45 RFT OLN:K552170663230
 20:54:54 LOGM Message:[011105150054000810](#) MessageType:Text Received:05/14/2011 20:53:32
 Comment:KOMINS,DANIEL
 20:55:06 LOGM Message:[011105150055000812](#) MessageType:Text Received:05/14/2011 20:53:33
 Comment:KOMINS,DANIEL

21:00:42 BACKER [#P111341735](#) UnitID:1C32 Type:81 CallLoc:1015 HAMPSTEAD LN, OB Location:1015
 HAMPSTEAD LN, OB

21:00:42 PRMPT [#P111341700](#) Comment:Preempted and dispatched to call #P111341735

21:16:07 ONSCN [#P111341735](#)
 21:16:25 CLEAR Type:81

21:47:18 MISC Plate:[502NHS](#) Comment:28
 21:47:33 LOGM Message:[011105150147001784](#) MessageType:Text Received:05/14/2011 21:47:20
 Comment:LOGM

22:23:52 DISPOS [#P111341873](#) Type:TS Location:ROBERTA RD/OCEAN SHORE BLVD, OB Plate:[A004SX](#)
 22:23:52 -PRIU
 22:30:23 OK
 22:30:39 INV Type:INVP Priority:1 Name:WELCH,PATRICK J Race:W Sex:M DOB:04/07/1986 Age:25
 Category:P
 23:16:42 *CLEAR Type:TS Dispo:NR DispoLevel:10

23:26:44 *RFT Plate:[095VIE](#)

23:35:50 *DISPOS [#P111341976](#) Type:EP Location:700 S NOVA RD, OB
 23:35:50 -PRIU
 23:37:17 *CLEAR Type:EP Dispo:NR DispoLevel:10

23:37:57 *RFT Plate:[G889RL](#)
 23:39:10 *RFT OLN:P323102841290
 [05/15/2011]
 00:01:10 *RFT Plate:[X302IW](#)
 00:02:34 *RFT Plate:[FRNCE](#)
 00:11:41 *OPOFF
 00:11:41 *LOGOFF

Output for: 2273

Detailed History for Unit 1652 Between 06/22/2011 12:40 And 06/22/2011 13:40 [Detail](#)

12:40:10 *LOGON Operator:1652 OperNames:MCGUIRE,SHON MobileId:M263

12:40:10 *OPON Operators:1652 OperNames:MCGUIRE,SHON

13:40:48 *OPOFF

13:40:48 *LOGOFF

Output for: 2273

Detailed History for Unit 1652 Between 06/22/2011 13:41 And 06/22/2011 13:41 Detail

13:41:02 *LOGON Operator:1652 OperNames:MCGUIRE,SHON MobileId:M263
13:41:02 *OPON Operators:1652 OperNames:MCGUIRE,SHON
13:41:41 *OPOFF
13:41:41 *LOGOFF

Output for: 2273

Detailed History for Unit **1B34** Between 07/01/2011 05:48 And 07/01/2011 18:08 Detail

05:48:02 *LOGON Operator:1652 OperNames:MCGUIRE,SHON MobileId:M263**05:48:02 *OPON** Operators:1652 OperNames:MCGUIRE,SHON**05:51:01 -AVLCNT**

07:28:25 *DISPOS [#P111820447](#) Type:EP Location:725 S YONGE ST, OB**07:28:25 -PRIU****07:38:16 *CLEAR** Type:EP Dispo:NR DispoLevel:10

07:50:08 *RFT Plate:[T154GK](#)**07:50:46 *RFT** Plate:[3612HG](#)**07:54:32 *RFT** Plate:[346NHS](#)**08:00:30 *RFT** Plate:[C977LE](#)**08:01:27 *RFT** Plate:[A779RF](#)

08:13:40 *DISPOS [#P111820508](#) Type:EP Location:ORMOND BREEZE MHP, OB**08:13:40 -PRIU****08:31:51 *RFT** Plate:[951VJS](#)**08:34:33 *RFT** Plate:[5 ANGELO](#)**08:34:47 CLEAR** Type:EP Dispo:NR DispoLevel:10

08:35:01 DISPOS [#P111820550](#) Type:TS Location:TOMOKA PLAZA, OB**08:35:01 -PRIU****08:35:09 MISC** Comment:UNREADABLE TAG**08:36:56 MISC** Plate:[5ANGEL0](#) Comment:1**08:37:10 LOGM** Message:[011107011237008704](#) MessageType:Text Received:07/01/2011 08:37:02
Comment:VALID**08:38:14 MISC** Plate:[2ANGEL0](#) Comment:M**08:38:26 LOGM** Message:[011107011238008726](#) MessageType:Text Received:07/01/2011 08:38:16
Comment:VALID TRL**08:39:13 *RFT** OLN:G532000644590**08:48:24 OK****08:55:19 *CLEAR** Type:TS Dispo:NR DispoLevel:10

08:55:44 XDISP [#P111820568](#)**08:55:44 -PRIU****08:58:26 *ONSCN****09:05:17 *MISC** Comment:SUBJECT WAS GIVEN ADVISE ON HOW TO SECURE HIS PROPERTY
BETTER AND TOLD TO BRING THE ANIMAL TO THE VET TO DETERMINE IF IT WAS
POISON THAT KILLED IT.**09:05:28 *CLEAR** Type:90 Dispo:NR DispoLevel:10

09:13:58 *RFT Plate:[J635UK](#)

09:18:03 *DISPOS [#P111820620](#) Type:EP Location:700 S NOVA RD, OB**09:18:03 -PRIU****09:28:22 *CLEAR** Type:EP Dispo:NR DispoLevel:10

09:31:00 *RFT Plate:[J04YFS](#)

09:32:00 DISPOS [#P111820644](#) Type:13 Location:ARROYO PKWY/S NOVA RD, OB Plate:[J04YFS](#)

09:32:00 -PRIU

09:42:14 *RFT **Name:EVAN,GENE DAVID Sex:M DOB:19700710**09:42:48 *RFT **OLN:E152284702500**09:44:19 CLEAR **Type:13 Dispo:NR DispoLevel:10**09:44:28 DISPOS **#P111820669 Type:17 Location:PALM PAINT, OB**

09:44:28 -PRIU

09:53:45 MISC **Comment:AM 115**09:53:50 MISC **Comment:1015***

09:57:25 OK

10:05:24 *CASE **Case#: VP110019763**10:32:07 *CLEAR **Type:17 Dispo:INC DispoLevel:0**10:44:45 BACKER **#P111820755 UnitID:10A50 Type:43 CallLoc:155 N RIDGEWOOD AV, OB Location:155 N RIDGEWOOD AV, OB**10:53:44 *CLEAR **Type:43**11:18:13 *RFT **Plate:638MLR**11:18:23 *RFT **Plate:AF8AOK**11:25:23 *RFT **Plate:B092NR**11:28:22 *DISPOS **#P111820850 Type:EP Location:1000 DERBYSHIRE RD, DB**

11:28:22 -PRIU

11:29:12 *RFT **Plate:015WWZ**11:30:44 *RFT **Plate:E242TR**11:34:30 *CLEAR **Type:EP Dispo:NR DispoLevel:10**11:39:49 *RFT **Plate:F741ZY**11:44:21 *RFT **Plate:Q703PU**11:44:31 *RFT **Plate:765NHS**11:45:42 *RFT **Plate:C556LG**11:46:48 *RFT **Plate:C536XC**12:18:10 *RFT **Plate:M523NN**12:21:52 *RFT **Name:RHODES,TAMMY JO Sex:F DOB:19720223**12:24:11 DISPOS **#P111820948 Type:13 Location:1310 FLEMING AV, OB**

12:24:11 -PRIU

12:26:37 *RFT **OLN:R320810725630**12:28:37 MISC **Plate:M523NN Comment:B**12:28:48 LOGM **Message:011107011628011624 MessageType:Text Received:07/01/2011 12:28:40****Comment:LOGM**12:30:15 *RFT **Plate:ABNM12**12:30:59 *RFT **Name:WAY,BRIAN KEITH Sex:M DOB:19781112**12:35:56 *CLEAR **Type:13 Dispo:NR DispoLevel:10**12:38:19 DISPOS **#P111820969 Type:49 Location:2003 LINDA AV, OB**

12:38:19 -PRIU

12:46:09 CLEAR **Type:49 Dispo:NR DispoLevel:10 Comment:-96**12:54:18 *RFT **Plate:H945MX**12:54:46 *RFT **Plate:J056XQ**12:58:51 *RFT **Plate:N158LG**13:05:19 *RFT **Plate:B306NV**13:06:35 *RFT **Plate:M945NR**

13:14:30 BACKER [#P111821019](#) UnitID:1B33 Type:THC CallLoc:1590 OLD KINGS RD, DB Location:1590 OLD KINGS RD, DB

13:20:42 *ONSCN

13:21:28 ONSCN

13:23:59 CLEAR Type:THC Dispo:NR DispoLevel:10 Comment:-96

13:24:04 BACKER [#P111821047](#) UnitID:1B30 Type:43 CallLoc:1454 OCEAN SHORE BLVD, OB Location:1454 OCEAN SHORE BLVD, OB

13:24:15 CHGLOC Location:1808 RIDGEWOOD AV, OB LocDesc:btwn ARRAGON ST and CALLE GRANDE ST

13:28:14 HOLD [#P111821065](#)

13:29:21 LOGM [#P111821047](#) Message:[011107011729012195](#) MessageType:Text Received:07/01/2011 13:29:14 Comment:LOGM

13:29:51 OK

13:30:17 *ONSCN

13:46:51 HOLD [#P111821065](#)

13:52:13 MISC [#P111821047](#) Comment:AF 10-15

13:53:59 MISC Comment:10-81

13:54:23 MISC Comment:10-39 TO UNIVERSAL

13:56:47 MISC Comment:VEN ENTERED INTO TOW FILE

14:32:18 OK

14:48:33 CHGLOC Location:FORTUNATO PARK, OB LocDesc:at 2 JOHN ANDERSON DR, OB LocCross:btwn E GRANADA BLVD and ORCHARD LN Comment:AF

14:57:02 OK

15:00:41 CHGLOC Location:LPGA BLVD/DERBYSHIRE RD, DB LocDesc: <1300/ 1100>

15:14:10 OK

15:16:04 *ONSCN

16:18:00 OK

16:45:58 CHGLOC Location:BJ, DB LocDesc:at 1300 RED JOHN DR, DB LocCross:btwn W INTL SPEEDWAY BLVD and END Comment:AF

16:50:29 CHGLOC Location:HUMANE SOCIETY, DB LocDesc:at 2364 LPGA BLVD, DB LocCross:btwn LPGA EB I-95 SB ON RAMP and I-95 SB LPGA OFF RAMP

16:51:44 OK

17:00:32 CLEAR Type:43 Dispo:INC DispoLevel:0

17:51:47 *RFT Plate:[Q406GY](#)

18:08:54 *OPOFF

18:08:54 *LOGOFF

Output for: 2273

Detailed History for Unit 1652 Between 07/04/2011 11:45 And 07/04/2011 13:14 Detail

11:45:15 *LOGON Operator:1652 OperNames:MCGUIRE,SHON MobileId:M263

11:45:15 *OPON Operators:1652 OperNames:MCGUIRE,SHON

11:46:59 -AVLCNT

13:14:04 *OPOFF

13:14:04 *LOGOFF

Output for: 2273

Detailed History for Unit 1652 Between 07/05/2011 07:13 And 07/05/2011 16:30 Detail

07:13:13 *LOGON Operator:1652 OperNames:MCGUIRE,SHON MobileId:M263
07:13:13 *OPON Operators:1652 OperNames:MCGUIRE,SHON
07:47:13 *OUT Location:DELAND COURTHOUSE, DEL Type:OUT Darea:DL RD:8341 TypeDesc:Out
LocDesc:at 101 N ALABAMA AV, DEL LocCross:btwn E INDIANA AV and E RICH AV
Priority:4 Response:1PAT Agency:DL Zone:DL03 Map:44 C3 LocType:C
07:51:41 OK
10:06:35 CHANGE Darea:ADM RD:8341 Agency:DL
11:11:28 -AVLCNT
16:04:08 *CLEAR Type:OUT Dispo:NR DispoLevel:10
16:30:07 *OPOFF
16:30:07 *LOGOFF

Output for: 2273

Detailed History for Unit 1652 Between 07/07/2011 18:46 And 07/07/2011 20:03 Detail

18:46:55 *LOGON Operator:1652 OperNames:MCGUIRE,SHON MobileId:M263

18:46:55 *OPON Operators:1652 OperNames:MCGUIRE,SHON

18:47:00 -AVLCNT

20:03:14 *OPOFF

20:03:14 *LOGOFF

Output for: 2273

Detailed History for Unit 1652 Between 07/10/2011 13:50 And 07/10/2011 15:06 [Detail](#)

13:50:01 *LOGON Operator:1652 OperNames:MCGUIRE,SHON MobileId:M263

13:50:01 *OPON Operators:1652 OperNames:MCGUIRE,SHON

13:51:17 -AVLCNT

15:06:48 *OPOFF

15:06:48 *LOGOFF

Output for: 2273

Detailed History for Unit **1B34** Between 07/12/2011 05:44 And 07/12/2011 18:24 Detail

05:44:31 *LOGON Operator:1652 OperNames:MCGUIRE,SHON MobileId:M263
05:44:31 *OPON Operators:1652 OperNames:MCGUIRE,SHON
05:44:32 -AVLCNT
07:05:51 *RFT Plate:[609AGE](#)
07:19:29 *RFT Plate:[V643DJ](#)

07:21:51 *DISPOS [#P111930394](#) Type:EP Location:ORMOND BREEZE MHP, OB
07:21:51 -PRIU
07:37:16 OK
07:42:31 *CLEAR Type:EP Dispo:NR DispoLevel:10

08:00:12 DISPOS [#P111930470](#) Type:TS Location:AVENUE E/PALM ST, OB Plate:[ABXC62](#)
08:00:12 -PRIU
08:00:36 MISC Comment:WEST ON AVEF ...
08:00:49 CLOS Location:1109 AVENUE F, OB LocDesc:btwn PALM ST and PINE DR
08:02:28 *RFT OLN:B525521885851
08:02:50 *RFT OLN:M532585845190
08:07:59 *RFT Name:BENJAMIN,LYNEA ALLYCE Sex:F DOB:19880305
08:11:15 *RFT VIN:1J4FX78S8WC309303
08:13:08 OK
08:16:48 *CASE Case#:VP110020825
08:25:44 MISC Comment:AF 1015 TRAFFIC
08:25:50 CLEAR Type:TS Dispo:INC DispoLevel:0 Comment:ROR'D

09:22:46 BACKER [#P111930608](#) UnitID:7B11 Type:81H CallLoc:SUBWAY, HH Location:SUBWAY, HH
09:25:17 ONSCN
09:26:29 *CLEAR Type:81H

09:34:30 XDISP [#P111930625](#)
09:34:30 -PRIU
09:36:26 *ONSCN
09:36:36 *RFT Plate:[S295HH](#)
09:36:51 *RFT Plate:[C328LF](#)
09:37:04 *RFT Plate:[305NHR](#)
09:40:29 *RFT Plate:[V759DK](#)
09:43:32 *RFT VIN:1NGSD1TS2NC345200
09:45:05 OK
09:50:12 *MISC Comment:R/O CAME OUT AND ADVISED HE WILL MOVE THE VEHICLES. BECKY AT CODE ENFORCEMENT WAS INFORMED
09:50:21 *CLEAR Type:83 Dispo:NR DispoLevel:10

10:05:28 DISP [#P111930692](#) Type:13A CallLoc:1320 HAND AV #18, OB
10:05:28 -PRIU
10:05:41 ENRTE
10:05:59 XPRMPT

10:16:20 DISP [#P111930711](#) Type:ESCORT CallLoc:1551 CROWNE VIEW DR #825, OB
10:16:20 -PRIU
10:16:32 ENRTE

10:27:19 PRMPT **Comment:**Preempted and dispatched to call #P111930701
 10:27:19 -HOLD

10:27:19 BACKUP **#P111930701 UnitID:**1B33 **Type:**21J **CallLoc:**1130 LEWIS DR, DB **Location:**1130 LEWIS DR, DB

10:28:18 *ONSCN

10:29:30 CLOS **Location:**6TH ST/DERBYSHIRE RD, DB **LocDesc:** <1300/ 900>

10:33:48 OK

10:38:19 *RFT **Plate:**624KDR

11:08:01 *CLEAR **Type:**21J

11:08:16 DISP **#P111930775 Type:**49 **CallLoc:**57 HIGHRIDGE RD, DB

11:08:25 ENRTE

11:17:16 ONSCN

11:23:46 OK

11:27:59 RFT **Name:**BARRETT,JAMES D **Sex:**M **DOB:**19851125

11:28:23 RFT **Name:**MEADE,BRITTANY A **Sex:**F **DOB:**19881129

11:29:05 LOGM **Message:**011107121529009209 **MessageType:**Text **Received:**07/12/2011 11:28:46
Comment:LOGM

11:29:11 LOGM **Message:**011107121529009222 **MessageType:**Text **Received:**07/12/2011 11:28:29
Comment:LOGM

11:33:41 *CLEAR **Type:**49

11:41:39 *RFT **Plate:**J798UN

11:43:38 *RFT **Plate:**768TWD

11:46:10 DISPOS **#P111930854 Type:**12 **Location:**FLOMICH ST/CENTER AV, HH

11:46:10 -PRIU

11:46:15 CHANGE **Type:**12F **TypeDesc:**Fleeing Driver

11:46:21 MISC **Comment:**EB ON FLOMICH

11:46:31 MISC **Comment:**FELONY CHARGES

11:46:48 MISC **Comment:**WB ON ALABAMA ..

11:47:22 MISC **Comment:**COMING TO NOVA BM ..BLK SHIRT ...GLOD SPORT BIKE

11:48:00 MISC **Comment:**CUT OFF ON A SIDE ROAD ...POSS EVERGREN OR PALM

11:48:10 MISC **Comment:**1B30 AWARE

11:51:15 CLOS **Location:**1715 PALM RD, OB **LocDesc:**btwn ALABAMA AV and GOLF AV

11:51:53 MISC **Comment:**PER S/700 SITE ...KLUGH,KENNETH B ..1715 PALM RD,OB ...

11:52:18 LOGM **Message:**011107121552009568 **MessageType:**Text **Received:**07/12/2011 11:52:08
Comment:S/700

11:53:59 LOGM **Message:**011107121553009590 **MessageType:**Text **Received:**07/12/2011 11:53:49
Comment:POSS SUSP

11:59:57 OK

12:03:40 *RFT **Name:**KLUGH,KENNETH BERNARD **Sex:**M **DOB:**19820811

12:12:53 CLOS **Location:**1711 N NOVA RD #A, HH **LocDesc:**btwn WALKER ST and 15TH ST

12:13:16 OK

12:29:06 CLEAR **Type:**12F **Dispo:**NR **DispoLevel:**10

12:29:08 DISP **#P111930908 Type:**13A **CallLoc:**HOLIDAY VILLAGE MHP #199, OB

12:29:08 -PRIU

12:43:20 ONSCN

12:43:36 OK **Comment:**EVENT NUMBER GIVEN

12:55:29 *MISC **Comment:**UNFOUNDED

12:56:11 *CLEAR **Type:**13A **Dispo:**NR **DispoLevel:**10

13:21:51 DISPOS [#P111930997](#) Type:49 Location:32 CIRCLE DR, OB
13:21:51 -PRIU
13:24:02 CLOS
13:24:25 OK
13:24:28 MISC Comment:10.25
13:28:14 CLEAR Type:49 Dispo:NR DispoLevel:10

13:30:45 *RFT Plate:[L880IK](#)

13:41:53 DISP [#P111931029](#) Type:22F CallLoc:1641 CARMEN AV, DB
13:41:53 -PRIU
13:44:22 ONSCN
13:46:01 *RFT Name:FILA,THAD J Sex:M DOB:19850323
13:54:36 *RFT Name:WALTER,MEGAN V Sex:F DOB:19800214
13:55:03 *RFT Name:REED,CHRISTOPHER ALLEN Sex:M DOB:19810826
13:56:50 OK
14:08:35 *CASE Case#:VP110020863
14:30:29 CHGLOC Location:LPGA BLVD/DERBYSHIRE RD, DB LocDesc: <1300/ 1100>
14:33:17 *ONSCN
14:33:25 OK
14:34:16 *RFT Name:FUTCH,CURTIS LLOYD Sex:M DOB:19810721
15:10:33 *CLEAR Type:22F Dispo:INC DispoLevel:0

15:12:45 DISP [#P111931187](#) Type:41H CallLoc:1506 SAN MARCO DR #103, OB
15:12:45 -PRIU
15:13:09 XPRMPT

15:34:36 BACKUP [#P111931217](#) UnitID:1B33 Type:43 CallLoc:13TH ST/CEDAR CIR, DB
Location:DERBYSHIRE RD/MASON AV, DB
15:34:39 ENRTE
15:40:09 *RFT Plate:[314MHM](#)
15:43:14 CLOS Location:57 HIGHRIDGE RD, DB LocDesc:btwn CEDAR CIR and VALLEY DR
Comment:WITH BRITTANY
15:46:24 RFT Name:MEADE,BRITTANY A Sex:F DOB:19881129
15:46:46 LOGM Message:[011107121946012567](#) MessageType:Text Received:07/12/2011 15:46:30
Comment:LOGM
15:49:51 MISC Comment:VICTIM CAME BACK TO THIS LOI
15:55:51 OK
16:23:59 MISC Plate:[M688NP](#) Comment:T
16:24:10 LOGM Message:[011107122024013064](#) MessageType:Text Received:07/12/2011 16:24:03
Comment:LOGM
17:20:24 *CLEAR Type:43

18:24:15 *OPOFF
18:24:15 *LOGOFF

Output for: 2273

Detailed History for Unit 1652 Between 07/13/2011 07:26 And 07/13/2011 15:16 [Detail](#)

07:26:28 *LOGON Operator:1652 OperNames:MCGUIRE,SHON MobileId:M263

07:26:28 *OPON Operators:1652 OperNames:MCGUIRE,SHON

07:26:29 -AVLCNT

15:16:17 *OPOFF

15:16:17 *LOGOFF

Output for: 2273

Detailed History for Unit **1B34** Between 07/20/2011 05:43 And 07/20/2011 18:24 [Detail](#)**05:43:58 *LOGON** Operator:1652 OperNames:MCGUIRE,SHON MobileId:M263

05:43:58 *OPON Operators:1652 OperNames:MCGUIRE,SHON

05:43:58 -AVLCNT08:36:01 *DISPOS [#P112010549](#) Type:EP Location:700 S NOVA RD, OB

08:36:01 -PRIU

08:37:47 OK

08:48:32 *CLEAR Type:EP Dispo:NR DispoLevel:10

09:43:49 *OUT Location:D3, HH Type:OUT Darea:HH RD:8115 TypeDesc:Out LocDesc:at 999 3RD ST, HH
LocCross:btwn EDDIE AV and N NOVA RD Priority:4 Response:IPAT Agency:HH
Zone:HH03 Map:20 A3 LocType:C

09:47:02 OK

10:08:28 *CHGLOC Location:TRAINING

10:26:06 *ONSCN

10:28:46 OK

11:03:36 *CLEAR Type:OUT Dispo:NR DispoLevel:10

11:15:59 DISPOS [#P112010815](#) Type:16 Location:BILL FRANCE BLVD/MASON AV, DB

11:15:59 -PRIU

11:18:00 *CLEAR Type:16 Dispo:NR DispoLevel:10

11:50:28 *DISPOS [#P112010878](#) Type:EP Location:ORMOND BREEZE MHP, OB

11:50:28 -PRIU

11:53:00 CLEAR Type:EP Dispo:NR DispoLevel:10

11:53:03 DISP [#P112010877](#) Type:83 CallLoc:1100 N US HWY 1, OB

11:53:03 -PRIU

11:53:06 CHGLOC Location:D3, HH LocDesc:at 999 3RD ST, HH LocCross:btwn EDDIE AV and N NOVA RD

11:53:25 XPRMPT

11:56:50 DISPOS [#P112010890](#) Type:EP Location:ORMOND BREEZE MHP, OB

11:56:50 -PRIU

11:56:54 OK

11:58:47 PRMPT Comment:Preempted and dispatched to call #P112010868

11:58:47 -HOLD

11:58:47 BACKER [#P112010868](#) UnitID:10A57 Type:DAV CallLoc:S NOVA RD/HAND AV, OB Location:S
NOVA RD/HAND AV, OB

12:01:10 *ONSCN

12:03:05 *CLEAR Type:DAV Dispo:NR DispoLevel:10

12:46:32 DISP [#P112010969](#) Type:4FMC CallLoc:273 N I-95, OB

12:46:32 -PRIU

12:46:42 ENRTE

12:54:15 *ONSCN

12:55:32 MISC Plate:[3762KY](#) Comment:TAG12:55:47 LOGM Message:[011107201655012721](#) MessageType:Text Received:07/20/2011 12:55:34
Comment:TAG

12:56:31 OK

13:00:33 MISC **Comment:FHP 10.97**
13:01:26 CLEAR **Type:4FMC Dispo:NR DispoLevel:10**

13:01:28 BACKER **#P112010999 UnitID:1B33 Type:13A CallLoc:1763 VALENCIA AV, OB Location:1763 VALENCIA AV, OB**
13:09:17 *ONSCN
13:10:20 OK
13:17:11 OK
13:17:43 RFT **Name:HARVEY,BRIAN D Sex:M DOB:19600719**
13:18:19 LOGM **Message:011107201718013057 MessageType:Text Received:07/20/2011 13:17:52 Comment:HARVEY 29 1054 VAL CLASS E EXP 2016**
13:21:32 RFT **Name:VORE,PATRICIA A Sex:F DOB:19631030**
13:21:51 LOGM **Message:011107201721013102 MessageType:Text Received:07/20/2011 13:21:33 Comment:VORE FL DL NOT VALID**
13:43:29 *CASE **Case#:VP110021749**
13:43:40 *CHGLOC **Location:HALIFAX HOSPITAL**
13:53:07 *ONSCN
14:03:24 OK
14:16:46 *CLEAR **Type:13A Dispo:INC DispoLevel:0**

14:46:35 DISP **#P112011197 Type:ESCORT CallLoc:1812 PALMER DR, OB**
14:46:35 -PRIU
14:58:12 ENRTE
15:02:26 *ONSCN
15:04:47 CHGLOC
15:06:48 *ONSCN
15:18:17 *RFT **Name:LITTLE,SHAWN MATTHEW Sex:M DOB:19910715**
15:22:49 *CLEAR **Type:ESCORT Dispo:NR DispoLevel:10**

16:37:07 *DISPOS **#P112011418 Type:EP Location:1200 FLOMICH ST,DB**
16:37:07 -PRIU
16:37:17 *CLEAR **Type:EP Dispo:NR DispoLevel:10**

16:37:29 *DISPOS **#P112011419 Type:EP Location:1200 FLOMICH ST, DB**
16:37:29 -PRIU
16:37:55 OK
16:38:02 *RFT **Name:GROTH,MARK STEVEN Sex:M DOB:19631127**
16:40:53 *CLEAR **Type:EP Dispo:NR DispoLevel:10**

16:47:42 DISP **#P112011442 Type:ATC CallLoc:1704 MONTGOMERY DR, DB**
16:47:42 -PRIU
16:47:55 PRMPT
16:47:55 -HOLD

16:52:27 *DISPOS **#P112011455 Type:17 Location:HALIFAX HOSPITAL**
16:52:27 -PRIU
17:03:36 OK
17:19:09 CLEAR **Type:17 Dispo:NR DispoLevel:10**

17:19:11 BACKER **#P112011502 UnitID:1B33 Type:22A CallLoc:1103 AVENUE H, OB Location:1103 AVENUE H, OB**
17:29:48 ONSCN
17:31:32 OK
17:48:25 -PRIU

18:06:33 *CLEAR Type:22A Dispo:NR DispoLevel:10

18:24:45 *OPOFF

18:24:45 *LOGOFF

Output for: 2273

Detailed History for Unit 1B34 Between 07/21/2011 05:38 And 07/21/2011 18:18 Detail

05:38:41 *LOGON Operator:1652 OperNames:MCGUIRE,SHON MobileId:M263
 05:38:41 *OPON Operators:1652 OperNames:MCGUIRE,SHON
 05:39:00 -AVLCNT
 07:19:22 *RFT Name:MOSCO,CHRISTIAN E Sex:M DOB:19720911

07:22:05 *DISPOS #P112020435 Type:83 Location:142 S PENINSULA DR #3, DB
 07:22:05 -PRIU
 07:22:25 *RFT Name:MOSCO,CHRISTIAN EUGENE Sex:M DOB:19720911
 07:26:32 OK
 07:30:50 *MISC Comment:ADDRESS AND DL VERIFIED. OFFENDER WATCH UPDATED
 07:30:59 *CLEAR Type:83 Dispo:NR DispoLevel:10

07:41:36 *RFT Plate:L751IJ
 07:51:13 *RFT Name:NASON,BETTY ANN Sex:F DOB:19681024
 07:51:28 *RFT Name:NASON,BETTY ANN Sex:F DOB:19681024

07:52:35 DISPOS #P112020484 Type:TS Location:OLD KINGS RD/LPGA BLVD, DB Plate:Z7DJZ
 07:52:35 -PRIU
 07:52:56 LOGM Message:011107211152007807 MessageType:Text Received:07/21/2011 07:52:48
 Comment:VALID
 07:53:38 *CLEAR Type:TS Dispo:NR DispoLevel:10

08:12:15 BACKUP #P112020489 UnitID:1B32 Type:81 CallLoc:1300 ANTRIM CIR, OB Location:1300 ANTRIM
 CIR, OB
 08:12:27 MISC Plate:A750RF Comment:T
 08:12:51 LOGM Message:011107211212008119 MessageType:Text Received:07/21/2011 08:12:39
 Comment:LOGM
 08:12:55 LOGM Message:011107211212008120 MessageType:Text Received:07/21/2011 08:12:30
 Comment:LOGM
 08:13:23 PRMPT

08:24:21 *DISPOS #P112020544 Type:83 Location:2003 LINDA AV #B, OB
 08:24:21 -PRIU
 08:25:21 *RFT Name:GREER,THERON OTIS Sex:M DOB:19780329
 08:39:26 *MISC Comment:ADDRESS VERIFIED. DL NOT UPDATED, SUBJECT HAS UNTIL THE END OF
 THE DAY ON FRIDAY, 07-22-2011 TO UPDATE IT. OFFENDER WATCH UPDATED
 08:40:02 *CLEAR Type:83 Dispo:NR DispoLevel:10

08:48:33 *BACKOS #P112020563 UnitID:1B33 Type:4 CallLoc:DERBYSHIRE RD/LPGA BLVD, DB
 Location:DERBYSHIRE RD/LPGA BLVD, DB
 08:49:13 OK
 08:58:39 *CLEAR Type:4

09:09:51 *DISPOS #P112020630 Type:17 Location:HALIFAX HOSPITAL
 09:09:51 -PRIU
 09:26:42 *CLEAR Type:17 Dispo:NR DispoLevel:10

09:31:50 *RFT Plate:J657HM
 09:33:40 *RFT Plate:582WQL
 09:34:51 *RFT Name:MULLER,MELISSA ANN Sex:F DOB:19820116

09:49:20 *RFT Plate:[384LKF](#)
 09:50:42 *RFT Plate:[384LKF/PC/KY/2010](#)
 09:54:43 *RFT Plate:[794XLA](#)
 09:56:18 *RFT Plate:[ABWU05](#)
 09:56:35 *RFT Plate:[L643IJ](#)

09:57:49 *DISPOS [#P112020716](#) Type:EP Location:700 S NOVA RD, OB
 09:57:49 -PRIU
 10:05:25 *CLEAR Type:EP Dispo:NR DispoLevel:10

10:11:04 *RFT Plate:[AMKL53](#)
 10:11:21 *RFT Plate:[AMKL53](#)
 10:11:48 *RFT Plate:[AMKE39](#)
 10:14:07 *RFT Plate:[202WWX](#)
 10:14:54 *RFT Plate:[202WWX](#)

10:16:01 *DISPOS [#P112020748](#) Type:EP Location:ORMOND BREEZE MHP, OB
 10:16:01 -PRIU
 10:26:12 *CLEAR Type:EP Dispo:NR DispoLevel:10

10:58:55 BACKOS [#P112020823](#) UnitID:10M13 Type:TS CallLoc:300-BLOCK CLYDE MORRIS BLVD, OB
 Location:300-BLOCK CLYDE MORRIS BLVD, OB
 11:01:23 *CLEAR Type:TS Dispo:NR DispoLevel:10

11:05:42 *DISPOS [#P112020841](#) Type:83 Location:1310 FLEMING AV #B31, OB
 11:05:42 -PRIU
 11:06:16 *RFT Name:HASKELL,GEORGE EDWARD Sex:M DOB:19211019
 11:09:43 *CLEAR Type:83 Dispo:NR DispoLevel:10

11:15:48 *RFT Plate:[E227RK](#)
 11:19:07 *RFT Plate:[N777YQ](#)
 11:25:50 *RFT Plate:[M412EN](#)

11:42:34 DISPOS [#P112020900](#) Type:49 Location:1101 AVENUE J, OB
 11:42:34 -PRIU
 11:49:25 CLOS Location:1702 AVENUE B, OB LocDesc:btwn PALM ST and PINE DR
 11:54:28 *RFT Plate:[J95IRA](#)
 11:54:47 *CLEAR Type:49 Dispo:NR DispoLevel:10

12:14:09 *RFT Plate:[819VJS](#)
 12:15:06 *RFT Name:DAUER,DAVID F Sex:M DOB:19650502
 12:22:08 *RFT Plate:[085XXB](#)
 12:25:44 *RFT Plate:[Y1JEQ](#)
 12:27:09 *RFT Plate:[ABNS96](#)
 12:28:08 *RFT Plate:[PA738K](#)
 12:29:16 *RFT Plate:[572WQK](#)

12:30:41 DISP [#P112020961](#) Type:22 CallLoc:3760 ROSCOMMON DR, OB
 12:44:22 ONSCN Comment:PLAZA
 12:45:28 MISC Comment:10-25, FR P-LOT
 12:50:36 *RFT OLN:P625296877540
 12:51:05 *RFT OLN:M245435774620
 12:53:39 MISC Plate:[MNW780/TX](#) Comment:GOLD HOND

12:54:21 MISC Plate:[YG5AW](#) Comment:B
 12:54:27 LOGM Message:[011107211654012025](#) MessageType:Text Received:07/21/2011 12:54:23 Comment:TX
 12:54:40 LOGM Message:[011107211654012027](#) MessageType:Text Received:07/21/2011 12:54:31 Comment:IN
 12:54:46 LOGM Message:[011107211654012029](#) MessageType:Text Received:07/21/2011 12:54:42 Comment:FL
 12:58:13 *RFT Name:MCCLANAHAN,JEREMY P Sex:M DOB:19771222
 13:10:31 *RFT Plate:[241433H/PC/IN/2010](#)
 13:25:09 *CLEAR Type:22

13:30:09 *RFT Plate:[AUIB44](#)
 13:48:47 *RFT Plate:[L076IP](#)
 14:00:24 *RFT Plate:[W024DA](#)
 14:04:00 *RFT Plate:[J17RKB](#)
 14:15:29 *RFT Plate:[Y9BHN](#)
 14:24:17 *RFT Plate:[H005MY](#)
 14:26:45 *RFT Name:DEGGES,JAY MICHAEL Sex:M DOB:19670218
 14:30:32 *RFT Plate:[9198LH](#)

14:32:35 DISPER [#P112021172](#) Type:22 CallLoc:1804 NELSON AV, OB
 14:32:35 -PRIU
 14:36:43 *ONSCN
 14:37:31 CLOS
 14:40:28 MISC Plate:[EHE6463](#) Comment:1
 14:40:36 MISC Plate:[ENC1561](#) Comment:1
 14:41:03 MISC Plate:[EHE6463/PC/NY/2012](#) Comment:1
 14:41:09 MISC Plate:[ENC1561/PC/NY/2012](#) Comment:1
 14:41:16 LOGM Message:[011107211841013343](#) MessageType:Text Received:07/21/2011 14:41:11
 Comment:VALID
 14:41:22 LOGM Message:[011107211841013344](#) MessageType:Text Received:07/21/2011 14:41:15
 Comment:VALID
 14:42:26 *RFT Name:KRYSHAK,ANTHONY M Sex:M DOB:19720125
 14:43:26 *RFT Name:KRYSHAK,ANTHONY M Sex:M DOB:19720125
 14:44:12 *RFT Name:MACCABEE,DONIMARIE F Sex:F DOB:19660402
 14:44:40 *RFT Name:MACCABEE,DONIMARIE F Sex:F DOB:19660402
 14:47:57 *RFT Name:MORRELL,DONOVAN ANGEL Sex:M DOB:19940428
 14:48:44 *RFT Plate:[562NHS](#)
 15:05:56 *CLEAR Type:33 Dispo:NR DispoLevel:10

15:45:24 DISPOS [#P112021284](#) Type:SS Location:N WILLIAMSON BLVD/STRICKLAND RANGE RD, DB
 15:45:24 -PRIU
 15:47:03 REDIR Darea:03 RD:9197 Agency:DB
 15:48:15 *RFT Name:WESSOL,TREVOR JOHN Sex:M DOB:19800722
 15:48:35 MISC Comment:TTY, S/8 ???
 15:49:04 OK Comment:IN/FL WESSOL, TREVOR J WM 072280
 15:49:25 RFT Name:WESSOL,TREVOR J Sex:M DOB:19800722
 15:50:04 LOGM Message:[011107211950014431](#) MessageType:Text Received:07/21/2011 15:49:29 Comment:REF
 S/8
 15:51:00 LOGM Message:[011107211951014459](#) MessageType:Text Received:07/21/2011 15:49:45 Comment:REF
 DL IN
 15:54:39 MISC Comment:WBC ON MALE HISTORY OF BEING S/20S AND NOT TAKING HIS MEDS
 15:55:15 MISC Comment:JON 812 466 7433
 16:15:52 CASE Case#:VP110021898

16:16:12 DISPER [#P112021335](#) Type:21B CallLoc:1605 RALEIGH AV, DB
 16:16:12 -PRIU

16:16:12 PRMPT [#P112021284](#) **Comment:**Preempted and dispatched to call #P112021335

16:21:51 *ONSCN [#P112021335](#)

16:36:46 MISC **Plate:**[8268JC/PC/MA/2011](#) **Comment:**T

16:37:02 LOGM **Message:**[011107212037015309](#) **MessageType:**Text **Received:**07/21/2011 16:36:50
Comment:LOGM

16:40:38 *MISC **Comment:**NO WAY TO DETERMINE A 21 TOOK PLACE. THE RESIDENCE WAS UNLOCKED, BUT THE IT APPEARS SOMEONE IS STILL REMOVING THE BELONGINGS. RP WAS GIVEN AN EVENT NUMBER AND THE RESIDENCE WAS SECURED. RP WAS ADVISED TO CALL BACK IF ANYTHING CHANGES AFTER SPEAKING WITH THE OWNER

16:40:56 *DISPOS [#P112021384](#) **Type:**17 **Location:**1745 RALIEGH AV,DB

16:40:56 -PRIU

16:40:56 *PRMPT [#P112021335](#) **Comment:**Preempted and dispatched to call #P112021384

16:40:56 -HOLD

16:43:31 HOLD [#P112021374](#)

16:50:59 *CHGLOC [#P112021384](#) **Location:**1745 MONTGOMER AV,DB

16:51:01 *ONSCN

16:51:39 *RFT **Plate:**[P485AQ](#)

16:56:45 *CLEAR **Type:**17 **Dispo:**NR **DispoLevel:**10

17:09:15 *OUT **Location:**D3, HH **Type:**OUT **Darea:**HH **RD:**8115 **TypeDesc:**Out **LocDesc:**at 999 3RD ST, HH
LocCross:btwn EDDIE AV and N NOVA RD **Priority:**4 **Response:**1PAT **Agency:**HH
Zone:HH03 **Map:**20 A3 **LocType:**C

17:27:34 OK

18:00:02 *CLEAR **Type:**OUT **Dispo:**NR **DispoLevel:**10

18:18:19 *OPOFF

18:18:19 *LOGOFF

Output for: 2273

Detailed History for Unit 1652 Between 07/22/2011 18:51 And 07/22/2011 20:29 Detail

18:51:08 *LOGON Operator:1652 OperNames:MCGUIRE,SHON MobileId:M263

18:51:08 *OPON Operators:1652 OperNames:MCGUIRE,SHON

18:51:10 -AVLCNT

20:29:09 *OPOFF

20:29:09 *LOGOFF

Output for: 2273

Detailed History for Unit 1B34 Between 07/25/2011 05:41 And 07/25/2011 06:27 Detail

05:41:32 *LOGON Operator:1652 OperNames:MCGUIRE,SHON MobileId:M263
05:41:32 *OPON Operators:1652 OperNames:MCGUIRE,SHON
05:41:46 *RFT Plate:DGA5I
05:52:47 *OUT Location:D3, HH Type:OUT Darea:HH RD:8115 TypeDesc:Out LocDesc:at 999 3RD ST, HH
LocCross:btwn EDDIE AV and N NOVA RD Priority:4 Response:1PAT Agency:HH
Zone:HH03 Map:20 A3 LocType:C

05:52:58 OK
05:56:29 -AVLCNT
06:27:56 LIA Operator:7835
06:27:56 -RELOG Operator:1652 7835 OperNames:MCGUIRE,SHON; MCDANIEL, KYLE Darea:03
UnitType:PM MobileTerm:M263 MobileId:M:175130

Output for: 2273

Detailed History for Unit 1B34 Between 07/25/2011 06:27 And 07/25/2011 10:43 [Detail](#)

06:27:56 LIA Operator:7835
 06:27:56 -RELOG Operator:1652 7835 OperNames:MCGUIRE,SHON; MCDANIEL, KYLE Darea:03
 UnitType:PM MobileTerm:M263 MobileId:M:175130
 06:28:13 *CLEAR Type:OUT Dispo:NR DispoLevel:10

06:58:43 *DISPOS #P112060366 Type:EP Location:725 S YONGE ST, OB
 06:58:43 -PRIU
 07:00:08 *CLEAR Type:EP Dispo:NR DispoLevel:10

07:01:33 *RFT Plate:DYD2982/PC/OH/2011

07:38:03 *DISPOS #P112060419 Type:83 Location:1310 FLEMING AV #B31, OB
 07:38:03 -PRIU
 07:38:29 *RFT Name:HASKELL,GEORGE E Sex:M DOB:19211019
 07:43:39 *MISC Comment:ADDRESS AND DL VERIFIED, OFFENDER WATCH UPDATED
 07:43:46 *CLEAR Type:83 Dispo:NR DispoLevel:10

07:44:15 BACKUP #P112060422 UnitID:1B30 Type:92FALN CallLoc:1700 VALENCIA AV, OB Location:1700
 VALENCIA AV, OB
 07:44:22 ENRTE
 07:45:25 CLEAR Type:92FALN

07:45:27 OK

07:59:07 *DISPOS #P112060456 Type:83 Location:1134 AVE J,OB
 07:59:07 -PRIU
 08:00:03 *RFT Name:GRIFFITHS,WAYNE Sex:M DOB:19520924
 08:07:04 *MISC Comment:CONTACT MADE WITH SUBJECT. ADDRESS AND DL VERIFIED. OFFENDER
 WATCH UPDATED
 08:07:28 *CLEAR Type:83 Dispo:NR DispoLevel:10

08:09:43 *RFT Name:CONN,MATTHEW STEPHEN Sex:M DOB:19780129

08:22:12 DISPOS #P112060500 Type:49 Location:FLOMICH ST/MONTGOMERY AV, HH
 08:22:12 -PRIU
 08:27:03 CLOS
 08:36:25 CLEAR Type:49 Dispo:NR DispoLevel:10 Comment:96

08:48:31 *RFT Plate:640WOK
 08:50:54 *RFT Plate:L154IP

08:54:15 *DISPOS #P112060553 Type:EP Location:700 S NOVA RD, OB
 08:54:15 -PRIU
 09:05:18 OK
 09:07:02 *CLEAR Type:EP Dispo:NR DispoLevel:10

09:08:47 BACKUP #P112060578 UnitID:7B11 Type:33 CallLoc:1559 HANCOCK LN, HH Location:1559
 HANCOCK LN, HH
 09:08:54 ENRTE

09:12:45 CLEAR Type:33 Comment:96

09:17:11 *DISPOS #P112060590 Type:17 Location:1510 RIDGEWOOD AV, HH

09:17:11 -PRIU

09:35:42 CLEAR Type:17

09:49:24 *RFT Plate:[DA6150](#)

09:49:43 *RFT Plate:[DA6150](#)

09:56:35 *RFT Plate:[AGPC12](#)

10:03:55 *RFT Plate:[COE11](#)

10:04:10 *RFT Plate:[COE11](#)

10:11:17 *RFT Plate:[1719GC](#)

10:12:54 *RFT Plate:[ALJR1](#)

10:14:14 *RFT Plate:[E981JA](#)

10:14:53 *RFT Plate:[AJKY79](#)

10:15:07 *RFT Plate:[335DXZ](#)

10:16:20 *RFT Plate:[N826KZ](#)

10:16:53 *RFT Plate:[864TTR](#)

10:17:33 *RFT Plate:[L503KZ](#)

10:18:43 *RFT Plate:[TVV975](#)

10:19:36 *RFT Plate:[958TWA](#)

10:19:53 *RFT Plate:[K661WW](#)

10:20:12 *RFT Plate:[J099TI](#)

10:21:53 *RFT Plate:[5342JA](#)

10:23:58 *RFT Plate:[G301MY](#)

10:25:04 *RFT Plate:[190VWV](#)

10:33:39 *RFT Plate:[ABNT94](#)

10:35:40 *RFT Plate:[942VJW](#)

10:38:00 *RFT Plate:[022YCS](#)

10:39:45 *RFT Plate:[692YCU](#)

10:43:18 *OPOFF

10:43:18 *LOGOFF

Output for: 2273

Detailed History for Unit 1B34 Between 07/25/2011 10:45 And 07/25/2011 18:03 Detail

10:45:38 *LOGON Operator:1652 OperNames:MCGUIRE,SHON MCDANIEL, KYLE MobileId:M263
 10:45:38 *OPON Operators:1652 7835 OperNames:MCGUIRE,SHON MCDANIEL, KYLE
 10:46:51 -AVLCNT

10:49:38 *DISPOS #P112060751 Type:EP Location:1200 FLOMICH ST, DB
 10:49:38 -PRIU
 10:52:16 RFT Name:PARKER ,JON ALAN Sex:M DOB:19551120
 10:54:24 OK
 10:54:34 OK
 10:54:50 LOGM Message:011107251454008749 MessageType:Text Received:07/25/2011 10:53:13
 Comment:PARKER ID CARD MI
 11:01:00 MISC Comment:A/M 10-15 S/27A
 11:01:04 CHANGE Type:27A Priority:2 TypeDesc:Trespassers
 11:01:19 *CASE Case#:VP110022273
 11:19:31 MISC Comment:HAVE PT LPGA/DERBY
 11:21:15 TRANSP Location:HUMANE SOCIETY, DB LocDesc:at 2364 LPGA BLVD, DB LocCross:btwn LPGA
 EB I-95 SB ON RAMP and I-95 SB LPGA OFF RAMP
 11:27:28 CMPLT
 11:40:40 OK
 11:48:11 *CLEAR Type:27A Dispo:INC DispoLevel:0

11:59:40 *OUT Location:DB PICKLES, OB Type:10A Darea:OB RD:7879 TypeDesc:Meal break LocDesc:at
 400 S NOVA RD, OB LocCross:btwn MORELAND BLVD and CAMELOT BLVD Priority:4
 Agency:OB Zone:OB6 Map:11 E3 LocType:C
 11:59:47 OK
 12:35:16 *CLEAR Type:10A Dispo:NR DispoLevel:10

12:42:03 DISPOS #P112060923 Type:17 Location:1386 WRIGHT ST, DB
 12:42:03 -PRIU
 13:01:19 OK
 13:04:49 MISC Plate:1J230HK Comment:,
 13:05:02 MISC Plate:J230HK Comment:,
 13:08:20 CLEAR Type:17

13:08:26 BACKUP #P112060955 UnitID:1B32 Type:17 CallLoc:1156 S NOVA RD, OB Location:1156 S NOVA RD,
 OB
 13:10:18 ENRTE
 13:10:32 ONSCN
 13:12:26 OK
 13:13:51 RFT Name:ROSASRAMOS,JAVIER J Sex:M DOB:19840525
 13:14:15 RFT OLN:P455720844460
 13:14:40 LOGM Message:011107251714010407 MessageType:Text Received:07/25/2011 13:14:01
 Comment:ROSAS-RAMOS.....WANT NEG....DL NOT VALID
 13:15:14 LOGM Message:011107251715010410 MessageType:Text Received:07/25/2011 13:14:47
 Comment:PAULINO NUNEZ...WANT NEG....VALID DL
 13:24:07 *CLEAR Type:17 Dispo:NR DispoLevel:10

13:27:36 DISPOS #P112061004 Type:FLAG Location:SAN JOSE BLVD/FLOMICH ST, DB
 13:27:36 -PRIU
 13:28:31 CLOS Location:1211 FLOMICH ST, DB LocDesc:btwn GRANADA AV and SAN JOSE BLVD

Comment:S/7 S/90
 13:32:04 MISC Plate:[ABNP68](#) Comment:28
 13:32:40 LOGM Message:[011107251732010867](#) MessageType:Text Received:07/25/2011 13:32:12
 Comment:ABNP68...NEG WANT...REG
 13:38:04 OK
 13:38:17 MISC Comment:PER ANIMAL CONTROL ON PRIVATE PROPERTY IT IS THE
 RESPONSIBILITY OF THE PROPERTY OWNER. IF ON RIGHT OF WAY WASTE
 MANAGEMENT. A/C DOES NOT PICK UP DEAD ANIMALS
 13:40:32 RFT Plate:[ABNP68](#)
 13:40:54 LOGM Message:[011107251740011063](#) MessageType:Text Received:07/25/2011 13:40:39 Comment:REG
 FOR ABNP68
 14:08:48 *MISC Comment:TURNED OVER TO ANIMAL CONTROL
 14:09:08 *CLEAR Type:FLAG Dispo:NR DispoLevel:10

14:24:00 *DISPOS #[P112061103](#) Type:83 Location:1809 WOODCREST DR, OB
 14:24:00 -PRIU
 14:24:36 *RFT Name:COLON,RODNEY Sex:M DOB:19630124

14:28:49 HOLD #[P112061110](#)

14:28:55 *MISC #[P112061103](#) Comment:contact made with subject address and DL verified. offender watch
 updated.
 14:29:05 *CLEAR Type:83 Dispo:NR DispoLevel:10

14:29:08 BACKER #[P112061110](#) UnitID:1B30 Type:22 CallLoc:949 ROSALIE DR, DB Location:949 ROSALIE
 DR, DB
 14:34:59 ONSCN
 14:43:48 *RFT Name:HARVEY,TODD DENNIS Sex:M DOB:19620822
 14:45:38 *RFT Name:FULFORD,AMANDA MARIE Sex:F DOB:19780717
 14:58:32 OK
 14:58:39 *CASE Case#:VP110022297
 15:04:27 MISC Comment:10-15
 15:15:16 CLOS Location:LPGA BLVD/DERBYSHIRE RD, DB LocDesc: <1300/ 1100>
 15:17:05 -PRIU
 15:17:24 *ONSCN
 15:31:37 OK
 16:11:16 *CLEAR Type:22 Dispo:INC DispoLevel:0

16:12:07 *RFT Plate:[538TWA](#)
 16:52:12 *RFT Name:FUTCH,HUSTON W Sex:M DOB:19890416
 18:03:40 *OPOFF
 18:03:40 *LOGOFF

Output for: 2273

Detailed History for Unit 1B34 Between 07/26/2011 05:40 And 07/26/2011 06:54 Detail

05:40:47 *LOGON Operator:1652 OperNames:MCGUIRE,SHON MobileId:M263

05:40:47 *OPON Operators:1652 OperNames:MCGUIRE,SHON

05:40:52 -AVLCNT

05:49:40 *OUT Location:D3, HH Type:OUT Darea:HH RD:8115 TypeDesc:Out LocDesc:at 999 3RD ST, HH
LocCross:btwn EDDIE AV and N NOVA RD Priority:4 Response:1PAT Agency:HH
Zone:HH03 Map:20 A3 LocType:C

05:49:53 OK

06:54:08 *CLEAR Type:OUT Dispo:NR DispoLevel:10

06:54:14 RELOG Operator:1652 7835 OperNames:MCGUIRE,SHON; MCDANIEL, KYLE Darea:03
MobileTerm:M263 MobileId:M:175130

Output for: 2273

Detailed History for Unit 1652 Between 07/28/2011 07:10 And 07/28/2011 16:35 Detail

07:10:29 *LOGON Operator:1652 OperNames:MCGUIRE,SHON MobileId:M263

07:10:29 *OPON Operators:1652 OperNames:MCGUIRE,SHON

07:10:36 -AVLCNT

07:47:46 *DISPOS #P112090419 Type:15 Location:DELAND COURTHOUSE, DEL

07:47:46 -PRIU

08:01:41 OK

16:03:23 *CLEAR Type:15 Dispo:NR DispoLevel:10

16:35:20 *OPOFF

16:35:20 *LOGOFF

Output for: 2273

Detailed History for Unit **1B34** Between 07/29/2011 05:43 And 07/29/2011 18:17 Detail

05:43:20 *LOGON Operator:1652 OperNames:MCGUIRE,SHON MCDANIEL, KYLE MobileId:M263
 05:43:20 *OPON Operators:1652 7835 OperNames:MCGUIRE,SHON MCDANIEL, KYLE
 05:45:18 *RFT Plate:[J201HI](#)
 05:47:53 *RFT Plate:[V323AJ](#)

07:36:07 *DISPOS [#P112100419](#) Type:EP Location:700 S NOVA RD, OB
 07:36:07 -PRIU
 07:41:18 *CLEAR Type:EP Dispo:NR DispoLevel:10

08:07:34 *RFT Plate:[AMKE14](#)
 08:07:57 *RFT Name:PORCELLI,JOSEPH Sex:M DOB:19600412
 08:08:38 *RFT Name:PORCELLI,JOSEPH Sex:M DOB:19600412

08:39:16 *DISPOS [#P112100537](#) Type:EP Location:SPRINGLEAF DR / GOLF AV,OB
 08:39:16 -PRIU
 08:48:23 *CLEAR Type:EP Dispo:NR DispoLevel:10

09:00:34 *DISPOS [#P112100563](#) Type:17 Location:347 MASON AVE,DB
 09:00:34 -PRIU
 09:14:57 *CLEAR Type:17 Dispo:NR DispoLevel:10

09:16:43 BACKER [#P112100584](#) UnitID:10A54 Type:81H CallLoc:185 W GRANADA BLVD #3, OB Location:185 W GRANADA BLVD #3, OB
 09:19:13 CHGLOC
 09:21:34 *CLEAR Type:81H

09:26:06 DISP [#P112100604](#) Type:86A CallLoc:CALLE GRANDE ST/FEC RR, OB
 09:26:06 -PRIU
 09:30:56 ONSCN

09:35:29 -AVLCNT

09:37:34 OK [#P112100604](#)
 10:06:40 MISC Comment:52531 SAFE...123NH SAFE
 10:07:01 MISC Comment:NEED A 10-81 JUST WEST OF THE TRACKS ON CALLE GRANDE ..DIRT ROAD ON THE NORTH SIDE
 10:07:11 MISC Comment:NEED A FLAT BED
 10:09:47 MISC Comment:10-39 UNIVERSAL
 10:10:39 *CASE Case#:VP110022743
 10:28:49 CLEAR Type:86A Dispo:INC DispoLevel:0

10:28:51 BACKER [#P112100715](#) UnitID:1B32 Type:13A CallLoc:1230 DENECE TER, DB Location:1230 DENECE TER, DB
 10:36:07 ONSCN
 10:36:56 CLOS Comment:OUT WITH THE VEHICLE
 10:37:19 MISC Plate:[0799YE](#) Comment:FL
 10:37:41 MISC Plate:[Q799YE](#) Comment:FL
 10:37:43 LOGM Message:[011107291437013151](#) MessageType:Text Received:07/29/2011 10:37:21 Comment:NRF FL 1054
 10:38:02 LOGM Message:[011107291438013160](#) MessageType:Text Received:07/29/2011 10:37:43 Comment:07

DODGE PK VALID 1054
 10:38:15 CLOS **Location:OLD KINGS RD/DENEECE TER, DB LocDesc: <1051/ 1201>**
 10:38:18 OK
 10:39:22 RFT **OLN:M320210790430**
 10:39:46 LOGM **Message:011107291439013176 MessageType:Text Received:07/29/2011 10:39:30**
Comment:LOGM
 10:40:06 MISC **Plate:098NHT Comment:,**
 10:40:18 LOGM **Message:011107291440013183 MessageType:Text Received:07/29/2011 10:40:09**
Comment:LOGM
 10:40:35 INV **Type:INVP Priority:1 Name:MEADOWS,ELLIOT DOB:02/03/1979 Age:32 Category:P**
 10:42:06 RFT **OLN:R255161680950**
 10:42:18 RFT **OLN:R500772640970**
 10:45:07 RFT **Name:GLAZEBROOK,JOSEPH L Sex:M DOB:19780316**
 10:47:50 INV **Type:INVP Priority:1 Name:RICHMOND,DAVID Sex:M DOB:03/15/1968 Age:43 Category:P**
 10:48:08 INV **Type:INVP Priority:1 Name:RYAN,ROBERT,L Sex:M DOB:03/17/1964 Age:47 Category:P**
 10:48:25 *MISC **Comment:SUBJECTS ADVISED THEY PURCHASED THE SHED FROM A MRS MITCHELL. SUBJECTS WILL BE MOVING THE SHED TO 767 ESPANOLA AV #9. SUBJECTS ARE POSITIVELY IDENTIFIED.**
 10:49:33 *CLEAR **Type:13A Dispo:NR DispoLevel:10**

10:55:28 *RFT **Plate:Z321FX**
 10:58:33 *OUT **Location:D3, HH Type:OUT Darea:HH RD:8115 TypeDesc:Out LocDesc:at 999 3RD ST, HH LocCross:btwn EDDIE AV and N NOVA RD Priority:4 Response:1PAT Agency:HH Zone:HH03 Map:20 A3 LocType:C**
 10:58:57 OK
 11:43:40 *CLEAR **Type:OUT**

12:00:31 BACKUP **#P112100874 UnitID:1B33 Type:13A CallLoc:1338 N NOVA RD, DB Location:1338 N NOVA RD, DB**
 12:01:58 *ONSCN
 12:04:44 *MISC **Comment:BAG OF CLOTHES**
 12:04:53 *CLEAR **Type:13A Dispo:NR DispoLevel:10**

12:45:17 DISP **#P112100953 Type:4 CallLoc:FAMILY DOLLAR, OB**
 12:45:17 -PRIU
 12:52:20 ENRTE
 12:57:45 *ONSCN
 12:58:13 *RFT **Plate:378VJW**
 12:58:40 *RFT **Plate:ABNK18**
 13:02:28 *RFT **Name:CRICHTON,TABATHA LYNN Sex:F DOB:19850827**
 13:03:59 *RFT **Name:LUGTIG,GEORGE ANTHONY Sex:M DOB:19400903**
 13:04:37 *RFT **Name:LUGTIG,GEORGE ANTHONY Sex:M DOB:19400903**
 13:08:15 OK
 13:14:56 *RFT **Plate:J31QHJ**
 13:15:37 *RFT **Plate:J31QHJ**
 13:17:03 *RFT **Plate:J31OHJ**
 13:26:07 *CLEAR **Type:4 Dispo:NR DispoLevel:10**

14:09:54 DISP **#P112101128 Type:13 CallLoc:1412 PRIMROSE LN, DB**
 14:09:54 -PRIU
 14:17:27 *ONSCN
 14:27:09 *CLEAR **Type:13 Dispo:NR DispoLevel:10**

14:42:30 DISPOS **#P112101198 Type:SS Location:1400-BLOCK PRIMROSE LN, DB**

14:42:30 -PRIU
 14:47:00 *RFT Plate:[543VJW](#)
 14:47:36 *CLEAR Type:SS Dispo:NR DispoLevel:10

15:38:01 *DISPOS #[P112101320](#) Type:EP Location:ORMOND BREEZE MHP, OB
 15:38:01 -PRIU
 15:51:30 CLEAR Type:EP Dispo:NR DispoLevel:10

15:51:37 DISP #[P112101339](#) Type:12 CallLoc:1405 GOLF AV, OB
 15:51:37 -PRIU
 15:53:43 PRMPT
 15:53:43 -HOLD

15:54:24 DISPOS #[P112101352](#) Type:13 Location:1500-BLOCK SPRINGLEAF DR, OB Plate:[AAH7813](#)
 15:54:24 -PRIU
 15:54:28 MISC Plate:[AAH7813/PC/NC/2011](#) Comment:T
 15:54:55 LOGM Message:[011107291954017630](#) MessageType:Text Received:07/29/2011 15:54:32
 Comment:LOGM
 15:54:55 MISC Plate:[AAH7817/PC/NC/2011](#) Comment:T
 15:55:42 LOGM Message:[011107291955017640](#) MessageType:Text Received:07/29/2011 15:55:00
 Comment:LOGM
 15:56:45 *RFT OLN:M660285931850
 15:57:08 *RFT OLN:35844299
 15:59:08 CLEAR Type:13 Dispo:NR DispoLevel:10

15:59:11 DISP #[P112101339](#) Type:12 CallLoc:1405 GOLF AV, OB
 15:59:11 -PRIU
 16:00:26 *ONSCN
 16:05:12 *RFT Name:COMPTON,ELIZABETH DORIS Sex:F DOB:19880309
 16:06:14 *RFT OLN:C513224885900
 16:06:45 *RFT Plate:[7188WB](#)
 16:07:17 *RFT Plate:[718BWB](#)
 16:07:35 *RFT Plate:[718B7WA](#)
 16:12:31 OK
 16:13:43 *CLEAR Type:12 Dispo:NR DispoLevel:10

17:07:24 DISPOS #[P112101481](#) Type:SS Location:ALCAZAR ST/VALENCIA AV, DB
 17:07:24 -PRIU
 17:08:25 RFT OLN:B346792811730
 17:08:35 OK
 17:10:14 LOGM Message:[011107292110018473](#) MessageType:Text Received:07/29/2011 17:08:33
 Comment:BUTLER DL SUSO SIG 900 NEG WANT
 17:14:18 *CLEAR Type:SS Dispo:NR DispoLevel:10

17:15:02 *RFT Plate:[T673XZ](#)
 17:18:32 *RFT Plate:[U231AN](#)
 17:19:34 *RFT Name:FIDANCE,PAUL JOSEPH Sex:M DOB:19780522

17:27:53 DISP #[P112101501](#) Type:20 CallLoc:725 PARQUE DR, OB
 17:27:53 -PRIU
 17:35:07 ONSCN
 17:44:23 *MISC Comment:SUBJECT DOES NOT MEET THE CRITERIA FOR BAKER ACT. WORKERS
 ONSCENE WILL KEEP THE TWO SUBJECTS IN QUESTION SEPARATE
 17:44:25 *CLEAR Type:20 Dispo:NR DispoLevel:10

17:57:57 *RFT Plate:T757ID
17:59:56 *RFT Plate:M40UP
18:07:19 *RFT Plate:4MAJOR
18:14:08 *RFT Plate:819VJS
18:14:37 *RFT Name:DAUER,DAVID F Sex:M DOB:19650502
18:15:30 *RFT Plate:M428NJ
18:17:17 *OPOFF
18:17:17 *LOGOFF

Output for: 2273

Detailed History for Unit **1B34** Between 07/30/2011 05:46 And 07/30/2011 18:13 Detail

05:46:00 *LOGON Operator:1652 OperNames:MCGUIRE,SHON MCDANIEL, KYLE MobileId:M263
05:46:00 *OPON Operators:1652 7835 OperNames:MCGUIRE,SHON MCDANIEL, KYLE
05:46:00 -AVLCNT
05:55:11 *OUT Location:D3, HH Type:OUT Darea:HH RD:8115 TypeDesc:Out LocDesc:at 999 3RD ST, HH
 LocCross:btwn EDDIE AV and N NOVA RD Priority:4 Response:1PAT Agency:HH
 Zone:HH03 Map:20 A3 LocType:C

06:01:14 OK
06:55:38 *CLEAR Type:OUT Dispo:NR DispoLevel:10

08:01:34 *DISPOS #P112110493 Type:EP Location:700 S NOVA RD, OB
08:01:34 -PRIU
08:01:55 OK
08:04:19 *CLEAR Type:EP Dispo:NR DispoLevel:10

10:03:39 *RFT Name:POWELL,THOMAS LEROY DOB:19761104
10:03:42 *RFT Name:POWELL,THOMAS LEROY Sex:M DOB:19761104
10:04:19 *RFT Name:POWELL,ROY EUGENE Sex:M DOB:19800109

10:15:33 BACKER #P112110657 UnitID:1B31 Type:92B CallLoc:17 JUNIPER DR, OB Location:17 JUNIPER DR,
 OB
10:31:00 *ONSCN
10:39:39 OK
10:48:05 CHGLOC Location:704, DB LocDesc:at 303 N CLYDE MORRIS BLVD, DB LocCross:btwn HILTON
 AV and MAYBERRY AV Comment:AD MALE B.A
10:51:00 *CASE Case#:VP110022851
11:14:29 ONSCN
11:14:34 OK
11:37:26 *CLEAR Type:92B Dispo:INC DispoLevel:0

11:43:03 DISP #P112110762 Type:THC CallLoc:799 S RIDGEWOOD AV, OB
11:43:03 -PRIU
11:52:15 *MISC Comment:10-68 GIVEN, RP REQUESTS EP OF HER RESIDENCE. SUBJECT WAS
 ALREADY SERVED ON HIS EXPARTE AND RELEASED BY ACT.
11:52:17 *CLEAR Type:THC Dispo:NR DispoLevel:10

12:47:29 DISP #P112110818 Type:49A CallLoc:BRANCH JAIL, DB
12:47:29 -PRIU
12:47:40 CHGLOC Location:CENTRAL, DB LocDesc:at 59 KEYTON DR, DB LocCross:btwn INDIAN LAKE RD
 and END
13:04:46 ONSCN
13:06:39 OK
13:16:52 *CHGLOC Location:BRANCH JAIL,DB
13:19:06 *ONSCN
13:21:09 OK
13:43:10 CLEAR Type:49A Dispo:NR DispoLevel:10

13:43:14 DISPER #P112110882 Type:43 CallLoc:1632 VALENCIA AV, DB
13:43:14 -PRIU
14:00:53 *ONSCN
14:22:26 *RFT Name:LIMARDO,DELIA ORTIZ Sex:F DOB:19160926

14:23:34 OK
14:26:39 *RFT Name:LIMARDO,RALPH LOUIS Sex:M DOB:19400831
14:29:53 *RFT Name:JACKSON,JOHNNY RAY Sex:M DOB:19700811
14:30:33 *RFT Name:HILLMON,LEWIS DAN Sex:M DOB:19650326
14:34:16 *CASE Case#:VP110022872
14:39:39 *RFT Plate:D199VI
14:41:09 *RFT Name:DALESANDRO,MARSHA P Sex:F DOB:19620102
14:49:53 *CLEAR Type:43 Dispo:INC DispoLevel:0

15:38:11 *DISPOS #P112111083 Type:EP Location:POWER LINES, OB
15:38:11 -PRIU
15:39:32 CHANGE Location:MYRTLE JO DR/SUNNY PALM DR, OB Darea:03 RD:350 Agency:VP Zone:34
Map:19 D1
15:39:35 CLOS
15:40:44 OK
15:51:47 *CLEAR Type:EP Dispo:NR DispoLevel:10

16:17:48 BACKUP #P112111132 UnitID:1B31 Type:22D CallLoc:2317 BONNIE VIEW DR, OB Location:2317
BONNIE VIEW DR, OB
16:17:57 PRMPT

16:25:56 DISP #P112111155 Type:42 CallLoc:VANGUARD MOTEL #11, OB
16:25:56 -PRIU
16:30:01 PRMPT

16:51:29 DISP #P112111208 Type:ATC CallLoc:1423 JACKSON AV, DB
16:51:29 -PRIU
16:59:37 *ONSCN
17:01:38 MISC Comment:NO ONE HOME
17:01:40 CLEAR Type:ATC Dispo:NR DispoLevel:10

17:02:15 DISP #P112111230 Type:13A CallLoc:FLEMING AV/LINDA AV, OB
17:02:15 -PRIU
17:05:35 PRMPT

18:12:03 *RFT Plate:IDF471
18:13:18 *OPOFF
18:13:18 *LOGOFF

Output for: 2273

Detailed History for Unit **1B34** Between 07/31/2011 05:40 And 07/31/2011 19:21 Detail**05:40:46 *LOGON** Operator:1652 OperNames:MCGUIRE,SHON MCDANIEL, KYLE MobileId:M263

05:40:46 *OPON Operators:1652 7835 OperNames:MCGUIRE,SHON MCDANIEL, KYLE

05:40:50 -AVLCNT08:02:32 *DISPOS [#P112120485](#) Type:EP Location:700 S NOVA RD, OB

08:02:32 -PRIU

08:14:07 *CLEAR Type:EP Dispo:NR DispoLevel:10

08:32:26 *RFT Name:POWELL,ROY EUGENE Sex:M DOB:19800109

08:32:37 *RFT Name:POWELL,ROY EUGENE Sex:M DOB:19800109

08:34:06 DISPOS [#P112120516](#) Type:49 Location:1596 MONTGOMERY AV, HH

08:34:06 -PRIU

08:39:46 OK

08:46:11 OK

08:47:15 LOGM Message:[011107311247008216](#) MessageType:Text Received:07/31/2011 08:46:51
Comment:LOGM

08:51:13 CLEAR Type:49 Dispo:NR DispoLevel:10

09:22:37 *RFT Name:FORD,DANNY COX Sex:M DOB:19520413

09:23:56 DISPER [#P112120582](#) Type:22D CallLoc:3700-BLOCK E INTL SPEEDWAY BLVD, DEL

09:23:56 -PRIU

09:26:29 PRMPT

09:27:30 BACKER UnitID:1B33 Type:22D CallLoc:BIRD NEST MOTEL, DB Location:3700-BLOCK E INTL
SPEEDWAY BLVD, DEL

09:27:39 XPRMPT

09:28:10 ONSCN [#P112120589](#)

09:28:13 DISPER Type:49A Location:799 RIDGEWOOD AV, HH

09:28:13 -PRIU

09:37:52 OK

09:45:00? MISC Comment:MR FORD WAS SERVED 49A AT 945

10:09:04 *CHGLOC Location:555 W GRANADA BLVD, OB LocDesc:btwn N ORCHARD ST and TOMOKA AV
Comment:W/ RESPONDANT TO PICK UP LAST OF BELONGINGS

10:18:45 *ONSCN

10:50:05 OK

10:58:07 *CLEAR Type:49A Dispo:NR DispoLevel:10

11:08:48 DISPOS [#P112120702](#) Type:FLAG Location:998 DERBYSHIRE RD, DB

11:08:48 -PRIU

11:21:34 OK

11:23:42 *RFT Name:TRUSSEL,ADAM PATRICK Sex:M DOB:19800215

11:32:01 *RFT Plate:[R884XE](#)

11:46:44 *CASE Case#:VP110022942

11:51:54 *CLEAR Type:FLAG Dispo:NR DispoLevel:10

11:52:29 DISP Type:FLAG CallLoc:998 DERBYSHIRE RD, DB

11:52:29 -PRIU

11:52:31 ONSCN

12:01:20 *CLEAR Type:FLAG Dispo:INC DispoLevel:0

12:09:30 *OUT **Location:**CHILI'S,OB **Type:**10A **Darea:**03 **TypeDesc:**Meal break **Priority:**4 **Agency:**VP
LocType:O

12:09:44 OK

12:52:27 *CLEAR **Type:**10A **Dispo:**NR **DispoLevel:**10

13:03:50 DISP **#P112120832** **Type:**21A **CallLoc:**DAYTONA AQUARIUM, DB

13:03:50 -PRIU

13:05:58 PRMPT

13:05:58 -HOLD

13:11:08 DISPOS **#P112120846** **Type:**13P **Location:**GOLF AV/SPRINGLEAF DR, OB

13:11:08 -PRIU

13:13:26 OK

13:14:08 MISC **Comment:**SCHERMER, LEANN D W/F 07 04 1980

13:16:08 RFT **Name:**SCHERMER,LEANN D **Sex:**F **DOB:**19800704

13:16:35 LOGM **Message:**011107311716010725 **MessageType:**Text **Received:**07/31/2011 13:16:10
Comment:SCHERMER FL DL NOT VLAI

13:16:38 OK

13:17:59 *CLEAR **Type:**13P **Dispo:**NR **DispoLevel:**10

13:53:29 *BACKER **#P112120899** **UnitID:**10A54 **Type:**24 **CallLoc:**220 N NOVA RD, OB **Location:**220 N NOVA RD,
OB

13:53:33 *ONSCN

13:53:37 *ONSCN

13:56:23 *RFT **Plate:**255VJW

13:58:38 OK

14:02:54 *CLEAR **Type:**24

14:52:09 *RFT **Name:**BURTON,CHRISTOPHER EUGENE **Sex:**M **DOB:**19821102

15:21:08 BACKOS **#P112121011** **UnitID:**1B33 **Type:**TS **CallLoc:**BOBBIE LEE DR/10TH ST, DB
Location:BOBBIE LEE DR/10TH ST, DB

15:27:21 *CLEAR **Type:**TS

16:12:12 *RFT **Plate:**4673KI

16:18:18 *RFT **Plate:**J788UL

16:20:14 *RFT **Plate:**ABX847

16:20:32 *RFT **Plate:**652MHR

16:23:02 *RFT **Plate:**482LJF

16:23:33 *RFT **Plate:**ANBC49

16:28:56 *RFT **Plate:**U018CS

16:30:28 *RFT **Plate:**N094LH

16:30:59 *RFT **OLN:**P362559665680

16:32:34 *RFT **Plate:**AEWX13

16:35:34 *RFT **Plate:**9809GE

16:35:53 *RFT **Plate:**D695VH

16:44:17 *RFT **Plate:**59AQM

16:46:12 *RFT **Plate:**577NHS

16:47:45 *RFT **Plate:**B483NS

16:48:09 *RFT **Plate:**B483NS

16:48:40 DISPOS **#P112121132** **Type:**TS **Location:**MANETTE CIR/OLD KINGS RD, DB **Plate:**B483NS

16:48:40 -PRIU

16:49:03 MISC **Comment:**DEACL W099UN
16:49:57 LOGM **Message:**[011107312049013105](#) **MessageType:**Text **Received:**07/31/2011 16:49:22
Comment:LOGM
16:50:45 *RFT **Plate:**[W099UN](#)
16:52:16 *RFT **Name:**HENRY,BEN ERIC **Sex:**M **DOB:**19600208
16:52:20 LOGM **Message:**[011107312052013142](#) **MessageType:**Text **Received:**07/31/2011 16:51:12
Comment:TAG DECAL SHOULD BE ATTACHED TO IS S/9
16:52:30 MISC **Comment:**HAS THE DECAL BUT NOT THE TAG
16:53:27 MISC **Comment:**A/M 10.15
16:54:50 MISC **Comment:**UNIVERSAL RESPONDING
16:56:44 *CASE **Case#:**VP110022966
17:00:40 OK
17:02:50 LOGM **Message:**[011107312102013275](#) **MessageType:**Text **Received:**07/31/2011 17:02:10
Comment:LOGM
17:14:00 *TRANSP **Location:**D3, HH **LocDesc:**at 999 3RD ST, HH **LocCross:**btwn EDDIE AV and N NOVA RD
17:18:21 *CMPLT
17:24:26 OK
17:24:43 INV **Type:**INVP **Priority:**1 **Name:**POWELL,ROY EUGENE **Race:**W **Sex:**M **DOB:**01/09/1980
Age:31 **Category:**P
17:28:06 *RFT **Name:**HENRY,BEN ERIC **Sex:**M **DOB:**19600208
18:25:49 MISC **Comment:**PT TO D3
18:55:47 *RFT **Plate:**[186IBV](#)
18:57:34 *CLEAR **Type:**TS **Dispo:**INC **DispoLevel:**0

19:00:27 *RFT **Plate:**[860NHS](#)

19:02:50 *BACKOS **#**[P112121282](#) **UnitID:**15D11 **Type:**TS **CallLoc:**REED CANAL RD/S NOVA RD, SD
Location:REED CANAL RD/S NOVA RD, SD
19:09:25 OK
19:15:28 *CLEAR **Type:**TS

19:21:44 *OPOFF
19:21:44 *LOGOFF

Output for: 2273

Detailed History for Unit 1D34 Between 08/07/2011 05:45 And 08/07/2011 06:16 Detail

05:45:54 *LOGON Operator:1652 OperNames:MCGUIRE,SHON MobileId:M263

05:45:54 *OPON Operators:1652 OperNames:MCGUIRE,SHON

05:45:54 -AVLCNT

06:15:19 DISP #P112190432 Type:22 CallLoc:1781 CHERRY LAUREL DR, OB

06:15:19 -PRIU

06:16:50 LIA Operator:7829

06:16:50 -RELOG Operator:1652 7829 OperNames:MCGUIRE,SHON; HILL, KELLY Darea:03 UnitType:PM
MobileTerm:M263 MobileId:M:175130

Output for: 2273

Detailed History for Unit **VC1652** Between 08/09/2011 18:54 And 08/09/2011 20:12 [Detail](#)

18:54:55 *LOGON Operator:1652 OperNames:MCGUIRE,SHON MobileId:M263

18:54:55 *OPON Operators:1652 OperNames:MCGUIRE,SHON

18:55:34 -AVLCNT

20:12:55 *OPOFF

20:12:55 *LOGOFF

Output for: 2273

Detailed History for Unit VC1652 Between 08/10/2011 07:14 And 08/10/2011 16:36 Detail

07:14:43 *LOGON Operator:1652 OperNames:MCGUIRE,SHON MobileId:M263

07:14:43 *OPON Operators:1652 OperNames:MCGUIRE,SHON

07:14:54 -AVLCNT

07:51:30 *OUT Location:DELAND COURTHOUSE, DEL Type:OUT Darea:DL RD:8341 TypeDesc:Out
LocDesc:at 101 N ALABAMA AV, DEL LocCross:btwn E INDIANA AV and E RICH AV
Priority:4 Response:1PAT Agency:DL Zone:DL03 Map:44 C3 LocType:C

07:52:04 CHANGE Darea:ROAM RD:8341 Agency:DL

07:54:27 OK

16:03:54 *CLEAR Type:OUT Dispo:NR DispoLevel:10

16:36:50 *OPOFF

16:36:50 *LOGOFF

Output for: 2273

Detailed History for Unit 1B34 Between 08/13/2011 05:43 And 08/13/2011 07:00 Detail

05:43:10 *LOGON Operator:1652 OperNames:MCGUIRE,SHON MobileId:M263**05:43:10 *OPON** Operators:1652 OperNames:MCGUIRE,SHON**05:43:11 -AVLCNT****07:00:18 LIA** Operator:7841**07:00:18 -RELOG** Operator:1652 7841 OperNames:MCGUIRE,SHON; SYLVESTER, DAVID Darea:03
UnitType:PM MobileTerm:M263 MobileId:M:175130

Output for: 2273

Detailed History for Unit 1B34 Between 08/14/2011 05:50 And 08/14/2011 05:58 [Detail](#)

05:50:12 LOGON Operator:1652 OperNames:MCGUIRE,SHON Darea:03

05:58:07 *RELOG Operator:1652 OperNames:MCGUIRE,SHON MobileId:M263

05:58:07 *OPON Operators:1652 OperNames:MCGUIRE,SHON

Output for: 2273

Detailed History for Unit 1B34 Between 08/14/2011 05:58 And 08/14/2011 07:02 Detail

05:58:07 *RELOG Operator:1652 OperNames:MCGUIRE,SHON MobileId:M263
05:58:07 *OPON Operators:1652 OperNames:MCGUIRE,SHON
06:01:14 -AVLCNT
07:02:15 LIA Operator:7841
07:02:15 -RELOG Operator:1652 7841 OperNames:MCGUIRE,SHON; SYLVESTER, DAVID Darea:03
UnitType:PM MobileTerm:M263 MobileId:M:175130

Output for: 2273

Detailed History for Unit VC1652 Between 08/15/2011 09:01 And 08/15/2011 13:00 [Detail](#)

09:01:35 *LOGON Operator:1652 OperNames:MCGUIRE,SHON MobileId:M263

09:01:35 *OPON Operators:1652 OperNames:MCGUIRE,SHON

09:01:36 -AVLCNT

12:57:18 *RFT Plate:[N913YP](#)

13:00:24 *OPOFF

13:00:24 *LOGOFF

Output for: 2273

Detailed History for Unit 1B34 Between 08/18/2011 05:39 And 08/18/2011 07:01 Detail

05:39:05 *LOGON Operator:1652 OperNames:MCGUIRE,SHON MobileId:M263

05:39:05 *OPON Operators:1652 OperNames:MCGUIRE,SHON

05:39:16 -AVLCNT

05:41:22 *BACKER #P112300391 UnitID:1B33 Type:40 CallLoc:LPGA BLVD/DERBYSHIRE RD, DB
Location:LPGA BLVD/DERBYSHIRE RD, DB

05:49:37 *ONSCN

05:50:57 OK

05:55:51 *CLEAR Type:40

06:00:17 *OUT Location:D3, HH Type:OUT Darea:HH RD:8115 TypeDesc:Out LocDesc:at 999 3RD ST, HH
LocCross:btwn EDDIE AV and N NOVA RD Priority:4 Response:1PAT Agency:HH
Zone:HH03 Map:20 A3 LocType:C

06:01:27 OK

06:53:34 *CLEAR Type:OUT Dispo:NR DispoLevel:10

07:01:10 LIA Operator:7841

07:01:10 -RELOG Operator:1652 7841 OperNames:MCGUIRE,SHON; SYLVESTER, DAVID Darea:03
UnitType:PM MobileTerm:M263 MobileId:M:175130

Output for: 2273

Detailed History for Unit 1B34 Between 08/23/2011 17:34 And 08/23/2011 17:35 [Detail](#)

17:34:40 *LOGON Operator:1652 OperNames:MCGUIRE,SHON SYLVESTER, DAVID MobileId:M263
17:34:40 *OPON Operators:1652 7841 OperNames:MCGUIRE,SHON SYLVESTER, DAVID
17:35:14 *OPOFF
17:35:14 *LOGOFF

Output for: 2273

Detailed History for Unit **1B34** Between 08/23/2011 17:35 And 08/23/2011 18:00 [Detail](#)

17:35:46 *LOGON Operator:1652 OperNames:MCGUIRE,SHON SYLVESTER, DAVID MobileId:M263
17:35:46 *OPON Operators:1652 7841 OperNames:MCGUIRE,SHON SYLVESTER, DAVID
18:00:09 *OPOFF
18:00:09 *LOGOFF

Output for: 2273

Detailed History for Unit **VC1652** Between 08/24/2011 07:19 And 08/24/2011 16:27 [Detail](#)**07:19:12 *LOGON** Operator:1652 OperNames:MCGUIRE,SHON MobileId:M263**07:19:12 *OPON** Operators:1652 OperNames:MCGUIRE,SHON**07:19:13 -AVLCNT****07:55:07 *OUT** Location:DELAND COURTHOUSE, DEL Type:OUT Darea:DL RD:8341 TypeDesc:Out
LocDesc:at 101 N ALABAMA AV, DEL LocCross:btwn E INDIANA AV and E RICH AV
Priority:4 Response:1PAT Agency:DL Zone:DL03 Map:44 C3 LocType:C**07:55:31 OK****15:53:29 *CLEAR** Type:OUT Dispo:NR DispoLevel:10**16:27:21 *OPOFF****16:27:21 *LOGOFF**

Output for: 2273

Detailed History for Unit **1B34** Between 08/26/2011 05:37 And 08/26/2011 05:40 [Detail](#)

05:37:08 LOGON Operator:1652 OperNames:MCGUIRE,SHON Darea:03

05:40:05 *RELOG Operator:1652 OperNames:MCGUIRE,SHON MobileId:M263

05:40:05 *OPON Operators:1652 OperNames:MCGUIRE,SHON

Output for: 2273

Detailed History for Unit 1B34 Between 08/26/2011 05:40 And 08/26/2011 06:24 Detail

05:40:05 *RELOG Operator:1652 OperNames:MCGUIRE,SHON MobileId:M263**05:40:05 *OPON** Operators:1652 OperNames:MCGUIRE,SHON**05:40:11 -AVLCNT****05:50:40 *OUT** Location:D3, HH Type:OUT Darea:HH RD:8115 TypeDesc:Out LocDesc:at 999 3RD ST, HH
LocCross:btwn EDDIE AV and N NOVA RD Priority:4 Response:1PAT Agency:HH
Zone:HH03 Map:20 A3 LocType:C**05:50:59 OK****06:10:02 PRMPT** Comment:Preempted and dispatched to call #P112380308

06:10:02 DISP #P112380308 Type:22D CallLoc:1635 VALENCIA AV, DB**06:10:06 ENRTE****06:15:29 ONSCN****06:19:25 OK****06:20:54 *MISC** Comment:NOT SURE WHERE DISPATCH WAS INFORMED IT WAS PHYSICAL, BUT RP
STATED SUBJECT WAS JUST YELLING AND HOLLERING. RP WAS AFRAID SUSPECT
WOULD BE PHYSICAL IF HE HAD THE OPPORTUNITY.**06:23:09 *RFT** Name:BOLES,BILLY RAY Sex:M DOB:19710310**06:23:52 *CLEAR** Type:22D Dispo:NR DispoLevel:10

06:24:12 RELOG Operator:7841 1652 OperNames:SYLVESTER, DAVID; MCGUIRE,SHON Darea:03
MobileTerm:M263 MobileId:M:175130

Output for: 2273

Detailed History for Unit **VC1652** Between 08/26/2011 18:47 And 08/26/2011 19:57 [Detail](#)

18:47:55 *LOGON Operator:1652 OperNames:MCGUIRE,SHON MobileId:M263

18:47:55 *OPON Operators:1652 OperNames:MCGUIRE,SHON

18:48:29 -AVLCNT

19:57:25 *OPOFF

19:57:25 *LOGOFF

Output for: 2273

Detailed History for Unit 1C34 Between 09/09/2011 06:57 And 09/09/2011 07:16 Detail

06:57:47 LOGON Operator:7837 1652 OperNames:PULLIN, TIMOTHY; MCGUIRE, SHON Darea:03
07:16:47 LOGOFF

Output for: 2273

Detailed History for Unit VC1652 Between 10/16/2011 14:06 And 10/16/2011 16:03 Detail

14:06:02 *LOGON Operator:1652 OperNames:MCGUIRE,SHON MobileId:M263

14:06:02 *OPON Operators:1652 OperNames:MCGUIRE,SHON

14:07:27 -AVLCNT

16:03:49 *OPOFF

16:03:49 *LOGOFF

Output for: 2273

Detailed History for Unit VC1652 Between 10/17/2011 07:20 And 10/17/2011 07:58 Detail

07:20:17 LOGON Operator:1652 OperNames:MCGUIRE,SHON Darea:ADM
07:58:43 *RELOG Operator:1652 OperNames:MCGUIRE,SHON MobileId:M263
07:58:43 *OPON Operators:1652 OperNames:MCGUIRE,SHON

Output for: 2273

Detailed History for Unit VC1652 Between 10/17/2011 07:58 And 10/17/2011 08:15 [Detail](#)

07:58:43 *RELOG Operator:1652 OperNames:MCGUIRE,SHON MobileId:M263

07:58:43 *OPON Operators:1652 OperNames:MCGUIRE,SHON

08:00:44 -AVLCNT

08:15:56 *OPOFF

08:15:56 *LOGOFF

Output for: 2273

Detailed History for Unit VC1652 Between 10/19/2011 16:09 And 10/19/2011 17:05 Detail

16:09:23 *LOGON Operator:1652 OperNames:MCGUIRE,SHON MobileId:M263

16:09:23 *OPON Operators:1652 OperNames:MCGUIRE,SHON

16:09:41 *RFT Plate:X541DK**16:11:25 -AVLCNT**

17:05:37 *OPOFF

17:05:37 *LOGOFF

Output for: 2273

Detailed History for Unit VC1652 Between 10/23/2011 05:44 And 10/23/2011 07:26 Detail

05:44:11 *LOGON Operator:1652 OperNames:MCGUIRE,SHON MobileId:M263

05:44:11 *OPON Operators:1652 OperNames:MCGUIRE,SHON

05:44:16 -AVLCNT

07:26:37 RELOG Operator:1652 OperNames:MCGUIRE,SHON Darea:ADM MobileTerm:M263
MobileId:M:175130

Output for: 2273

Detailed History for Unit **VC1652** Between 10/23/2011 07:52 And 10/23/2011 07:52 [Detail](#)

07:52:15 *LOGON Operator:1652 OperNames:MCGUIRE,SHON MobileId:M263

07:52:15 *OPON Operators:1652 OperNames:MCGUIRE,SHON

07:52:45 *OPOFF

07:52:45 *LOGOFF

Output for: 2273

Detailed History for Unit VC1652 Between 10/23/2011 08:06 And 10/23/2011 08:45 [Detail](#)

08:06:07 *LOGON Operator:1652 OperNames:MCGUIRE,SHON MobileId:M263

08:06:07 *OPON Operators:1652 OperNames:MCGUIRE,SHON

08:45:39 *OPOFF

08:45:39 *LOGOFF

Output for: 2273

Detailed History for Unit VC1652 Between 10/23/2011 13:00 And 10/23/2011 13:11 [Detail](#)

13:00:04 *LOGON Operator:1652 OperNames:MCGUIRE,SHON MobileId:M263

13:00:04 *OPON Operators:1652 OperNames:MCGUIRE,SHON

13:00:12 -AVLCNT

13:11:05 RELOG -Operator:1652 OperNames:MCGUIRE,SHON Darea:ADM MobileTerm:M263
MobileId:M:175130

Output for: 2273

Detailed History for Unit VC1652 Between 10/26/2011 05:37 And 10/26/2011 05:46 Detail

05:37:34 *LOGON Operator:1652 OperNames:MCGUIRE,SHON MobileId:M263

05:37:34 *OPON Operators:1652 OperNames:MCGUIRE,SHON

05:37:39 -AVLCNT

05:46:48 *OPOFF

05:46:48 *LOGOFF

Output for: 2273

Detailed History for Unit **VC1652** Between 10/27/2011 13:02 And 10/27/2011 13:08 [Detail](#)

13:02:48 *LOGON Operator:1652 OperNames:MCGUIRE,SHON MobileId:M263

13:02:48 *OPON Operators:1652 OperNames:MCGUIRE,SHON

13:08:35 *OPOFF

13:08:35 *LOGOFF

Output for: 2273

Detailed History for Unit VC1652 Between 10/27/2011 17:46 And 10/27/2011 18:30 Detail

17:46:01 *LOGON Operator:1652 OperNames:MCGUIRE,SHON MobileId:M263

17:46:01 *OPON Operators:1652 OperNames:MCGUIRE,SHON

17:46:02 -AVLCNT

18:30:04 *OPOFF

18:30:04 *LOGOFF

Output for: 2273

Detailed History for Unit VC1652 Between 10/28/2011 09:47 And 10/28/2011 11:18 [Detail](#)

09:47:40 *LOGON Operator:1652 OperNames:MCGUIRE,SHON MobileId:M263

09:47:40 *OPON Operators:1652 OperNames:MCGUIRE,SHON

09:50:50 -AVLCNT

11:18:04 *OPOFF

11:18:04 *LOGOFF

Output for: 2273

Detailed History for Unit VC1652 Between 11/06/2011 23:43 And 11/06/2011 23:46 Detail

23:43:54 LOGON Operator:1652 OperNames:MCGUIRE,SHON Darea:ADM
23:46:39 *RELOG Operator:1652 OperNames:MCGUIRE,SHON MobileId:M263
23:46:39 *OPON Operators:1652 OperNames:MCGUIRE,SHON

Output for: 2273

Detailed History for Unit **VC1652** Between 11/06/2011 23:46 And 11/07/2011 00:19 [Detail](#)

23:46:39 *RELOG Operator:1652 OperNames:MCGUIRE,SHON MobileId:M263

23:46:39 *OPON Operators:1652 OperNames:MCGUIRE,SHON

23:46:43 -AVLCNT

[11/07/2011]

00:19:00 *OPOFF

00:19:00 *LOGOFF

03-01-2012 SGT TATUM met with CHIEF COFFIN and completed a cursory search in Force Watch from June 1, 2011 thru February 1, 2012 regarding an anonymous allegation that SGT MCGUIRE was hanging out at [REDACTED]

The results of the cursory search in Force Watch did not reveal SGT MCGUIRE on-duty at the alleged address. The complaint was then given to MAJOR JONES for review and action.

03-09-2012 LT EAGAN received the anonymous complaint from MAJOR JONES after he met with SGT MCGUIRE and he affirmed that he was having an extramarital relationship with the alleged party. MAJOR JONES concluded the meeting and referred the administrative investigation to Internal Affairs for review and action.

SHERIFF JOHNSON ordered the administrative investigation into the allegation of misconduct by SGT MCGUIRE. SGT TATUM and INV BENNETT served SGT MCGUIRE with his Notice of Internal Investigation.

LT EAGAN received AVL data compiled by SO Info Systems that was originally sent to MAJOR JONES for review.

03-12-2012 LT EAGAN reviewed ForceWatch for possible contacts with SGT MCGUIRE at Ms. GITTNER's home, [REDACTED]. LT EAGAN expanded the search area encompassing the entire peninsula from March 12, 2011 until March 12, 2012. During this query LT EAGAN noticed that on September 19, 2011 then Deputy MCGUIRE drove south on Atlantic Ave. (past the general area where GITTNER lives) and west on Dunlawton Ave. to his home [REDACTED].

INV GABRIEL conducted a drive-by of GITTNER's residence to attempt to verify that she still lives at the [REDACTED]. GITTNER's vehicle was not located during this attempt.

03-14-2012 LT EAGAN met with County Attorney Nancye Jones to review potential interview questions for SGT MCGUIRE and Ms. GITTNER.

03-15-2012 LT EAGAN received a call from County Attorney Nancye Jones and she told him that she did have any concerns with the questions shown to her. She was going to contact Ms. GITTNER's attorney and try to arrange a meeting or obtain a phone number for Ms. GITTNER.

03-16-2012 LT EAGAN received an email from County Attorney Nancye Jones forwarding email correspondence between Ms. GITTNER's attorney and

her. Ms. GITTNER's attorney, Melissa MURPHY indicated in the email to Ms. JONES that her client "is declining to be interviewed as a witness."

LT EAGAN attempted to contact SGT MCGUIRE via his department issued cell phone/Nextel and was unable. He left a voice mail message and SGT MCGUIRE returned his call a few minutes later. LT EAGAN set up an appointment for SGT MCGUIRE's interview on March 22, 2012 at 1000 hours.

- 03-21-2012 LT EAGAN completed a sampling of SGT MCGUIRE's AVL (automated vehicle locator) performance during the months of April, May, June, July, August, September, October, November 2011.
- 03-22-2012 LT EAGAN and SGT TATUM interviewed SGT MCGUIRE at the IA interview room. Also present was Teamster Reps Josh Vedder and Bob Walker.
- 04-10-2012 LT EAGAN presented the administrative investigation to the Sheriff and his executive staff.